

GENERATOR EXHAUST CATALOGUE

*Industrial Grade Silencer
Residential Grade Silencer
Critical Grade Silencer
Spark Arrestor
Oxidation Catalysts
Standart Silences
Special Productions*



hObi®

Exhaust Systems
Emission Control Systems
Air Tanks & Fuel Tanks

Hobi Exhaust is the leading supplier of exhaust systems and all its components and specialized in power- generator industry applications. The company manufactures exhausts of any sizes and diameters, silencers, exhaust pipes, interlock type exhaust flexible, stainless steel flexible bellows, compensators, all shapes and diameters of exhaust clamps, vibration insulators, as well as air and water pipes for radiators.

Hobi has the capability of developing designs for complete exhaust systems using computer simulation software according to the engine data obtained from the assembler or gen-set producer.

Thus, Hobi prefers to customize the production according to the customer needs to find out the most effective solution for the best sound attenuation. With the technical capacity & team work, we offer any absorption, reflection or diffusion types which will match customer requirement.



INDUSTRIAL GRADE SILENCER

4

MJI-E Sries
MJL-E series
MJZ-E Series

RESIDENTIAL GRADE SILENCER

7

MJI-R Sries
MJL-R series
MJZ-R Series

CRITICAL GRADE SILENCER

10

MJI-K Sries
MJL-K series
MJZ-K Series

SPARK ARRESTOR

13

OXIDATION CATALYSTS

14

55099-3" Universal Oxi-Cat
55467-3,5" Universal Oxi-Cat
55491-5" Universal Oxi-Cat
54999-6" Universal Oxi-Cat
55529-8" Universal Oxi-Cat
51853-10" Universal Oxi-Cat

STANDART TYPE SILENCER

17

55522 (10-60 KVA)
55523 (60-150 KVA)
55532 (150-300 KVA)
55533 (300-500 KVA)

SPECIAL PRODUCTIONS

19

MJE004
MJE005
MJE006
MJE007
MJE008
MJE021
MJE025
MJE028

UNIVERSAL

27

INDUSTRIAL GRADE SILENCER 12-18 dB(A)

This sturdy, robust silencer works well for equipment operating in environments where noise levels are high. Applications include commercial, industrial, mining, etc.

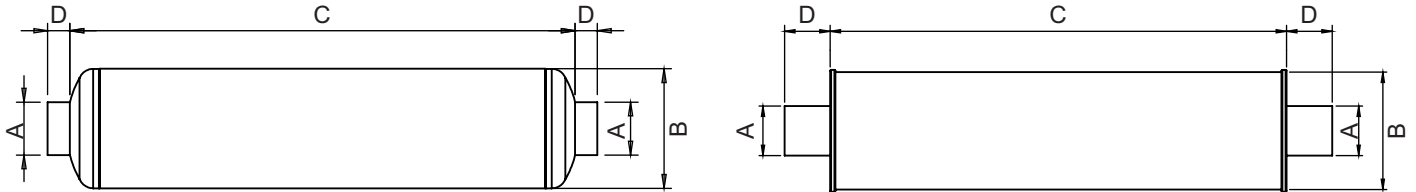

PART NUMBER	COVER TYPE	DIMENSIONS (mm.)				WEIGHT (kg.)
		A	B	C	D	
MJI01-E	STRAIGHT	50,8	200	600	80	
MJI02-E		63,5	200	600	80	
MJI03-E		76,2	250	800	80	
MJI04-E		88,9	300	800	80	
MJI05-E		101,6	400	1200	100	
MJI06-E	CAMBERED	127	400	1200	100	
MJI07-E		152,4	500	1500	150	
MJI08-E		203,2	600	1700	150	
MJI09-E		254	800	2000	150	
MJI10-E		304,8	800	2300	150	
MJI11-E		355,6	900	2300	150	
MJI12-E		406,6	900	2800	150	
MJI13-E		457,2	1100	3400	150	
MJI14-E		508	1100	3400	150	

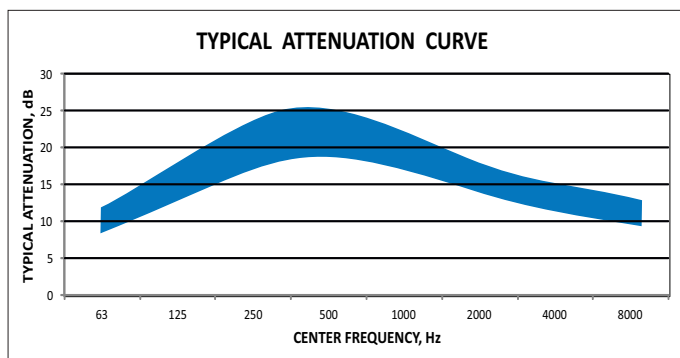

STANDARD CONSTRUCTION

- Dual shell construction to eliminate shell radiated noise and increase durability
- Aluminized/carbon steel construction
- Coated with satin black paint rated to 1200°F
- Connections:
 - Male NPT on 3.5" and smaller
 - 125/150# ANSI flanges on 4" and larger
- Stainless steel and additional inlet/outlet options available – Contact factory for details

CUSTOMIZATION

- Chart refers to standard product offering
- Custom configurations, materials, connections, overall dimensions, etc.
- Contact factory with your project's design requirements and specifications

INDUSTRIAL GRADE SILENCER 12-18 dB(A)

This sturdy, robust silencer works well for equipment operating in environments where noise levels are high. Applications include commercial, industrial, mining, etc.

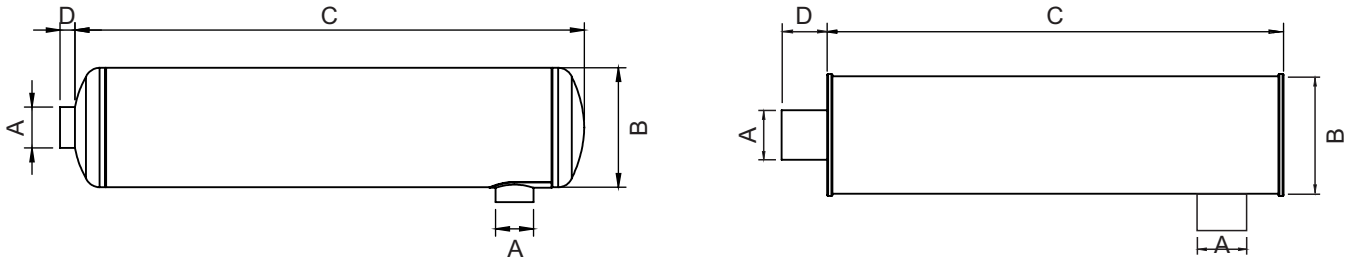

PART NUMBER	COVER TYPE	DIMENSIONS (mm.)				WEIGHT (kg.)
		A	B	C	D	
MJL01-E	STRAIGHT	50,8	200	600	80	
MJL02-E		63,5	200	600	80	
MJL03-E		76,2	250	800	80	
MJL04-E		88,9	300	800	80	
MJL05-E		101,6	400	1200	100	
MJL06-E	CAMBERED	127	400	1200	100	
MJL07-E		152,4	500	1500	150	
MJL08-E		203,2	600	1700	150	
MJL09-E		254	800	2000	150	
MJL10-E		304,8	800	2300	150	
MJL11-E		355,6	900	2300	150	
MJL12-E		406,6	900	2800	150	
MJL13-E		457,2	1100	3400	150	
MJL14-E		508	1100	3400	150	

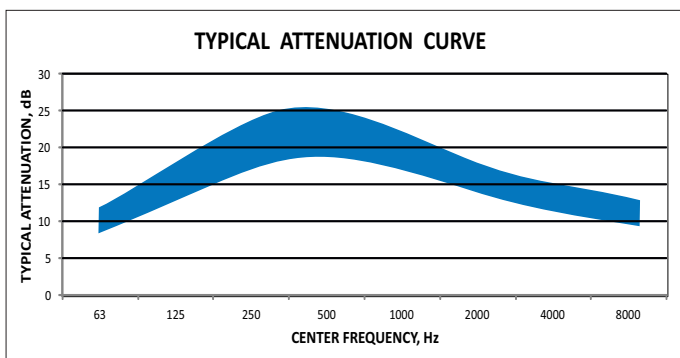

STANDARD CONSTRUCTION

- Dual shell construction to eliminate shell radiated noise and increase durability
- Aluminized/carbon steel construction
- Coated with satin black paint rated to 1200°F
- Connections:
 - Male NPT on 3.5" and smaller
 - 125/150# ANSI flanges on 4" and larger
- Stainless steel and additional inlet/outlet options available – Contact factory for details

CUSTOMIZATION

- Chart refers to standard product offering
- Custom configurations, materials, connections, overall dimensions, etc.
- Contact factory with your project's design requirements and specifications

INDUSTRIAL GRADE SILENCER 12-18 dB(A)

This sturdy, robust silencer works well for equipment operating in environments where noise levels are high. Applications include commercial, industrial, mining, etc.

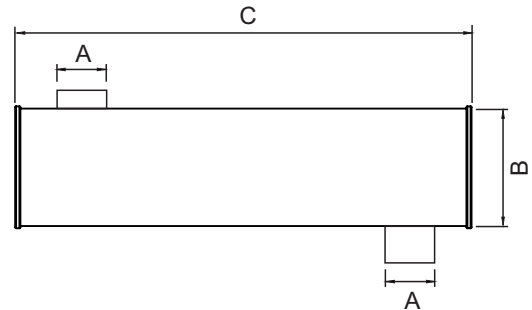
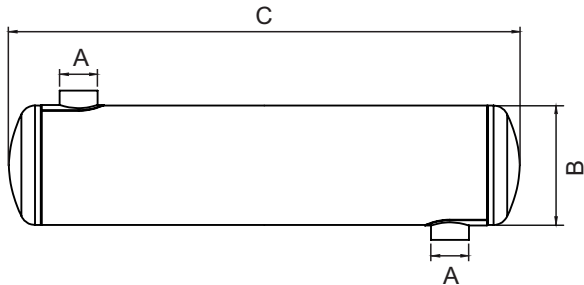

PART NUMBER	COVER TYPE	DIMENSIONS (mm.)				WEIGHT (kg.)
		A	B	C	D	
MJZ01-E	STRAIGHT	50,8	200	600	80	
MJZ02-E		63,5	200	600	80	
MJZ03-E		76,2	250	800	80	
MJZ04-E		88,9	300	800	80	
MJZ05-E		101,6	400	1200	100	
MJZ06-E	CAMBERED	127	400	1200	100	
MJZ07-E		152,4	500	1500	150	
MJZ08-E		203,2	600	1700	150	
MJZ09-E		254	800	2000	150	
MJZ10-E		304,8	800	2300	150	
MJZ11-E		355,6	900	2300	150	
MJZ12-E		406,6	900	2800	150	
MJZ13-E		457,2	1100	3400	150	
MJZ14-E		508	1100	3400	150	

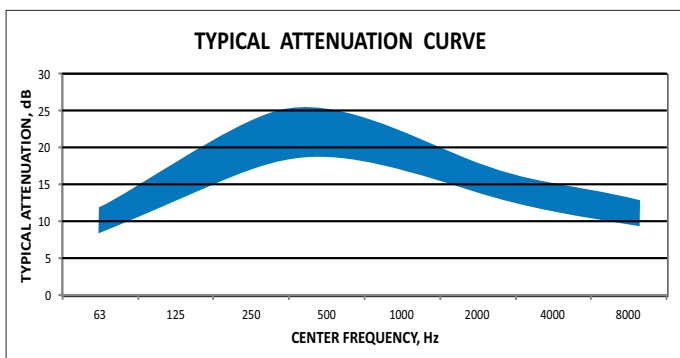

STANDARD CONSTRUCTION

- Dual shell construction to eliminate shell radiated noise and increase durability
- Aluminized/carbon steel construction
- Coated with satin black paint rated to 1200°F
- Connections:
 - Male NPT on 3.5" and smaller
 - 125/150# ANSI flanges on 4" and larger
- Stainless steel and additional inlet/outlet options available – Contact factory for details

CUSTOMIZATION

- Chart refers to standard product offering
- Custom configurations, materials, connections, overall dimensions, etc.
- Contact factory with your project's design requirements and specifications

RESIDENTIAL GRADE SILENCER 18-25 dB(A)

This heavy-duty silencer offers practical attenuation for equipment operating in environments where noise levels are moderate.
Applications include commercial, industrial, mining, etc.

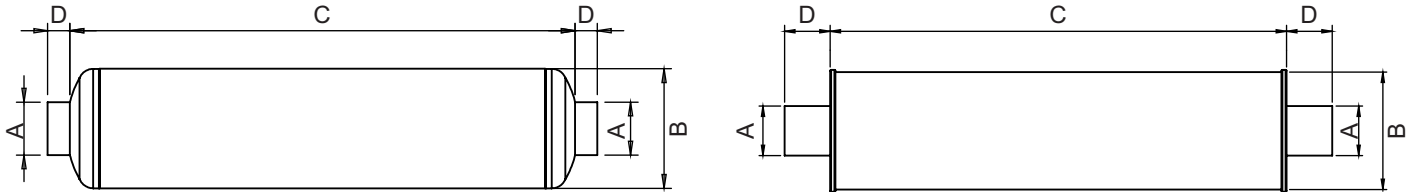

PART NUMBER	COVER TYPE	DIMENSIONS (mm.)				WEIGHT (kg.)
		A	B	C	D	
MJI01-R	STRAIGHT	50,8	200	800	80	
MJI02-R		63,5	200	800	80	
MJI03-R		76,2	250	1000	80	
MJI04-R		88,9	300	1000	80	
MJI05-R		101,6	400	1450	100	
MJI06-R	CAMBERED	127	400	1450	100	
MJI07-R		152,4	500	1700	150	
MJI08-R		203,2	600	2250	150	
MJI09-R		254	800	2800	150	
MJI10-R		304,8	800	2800	150	
MJI11-R		355,6	900	2860	150	
MJI12-R		406,6	900	3350	150	
MJI13-R		457,2	1100	3900	150	
MJI14-R		508	1100	3900	150	

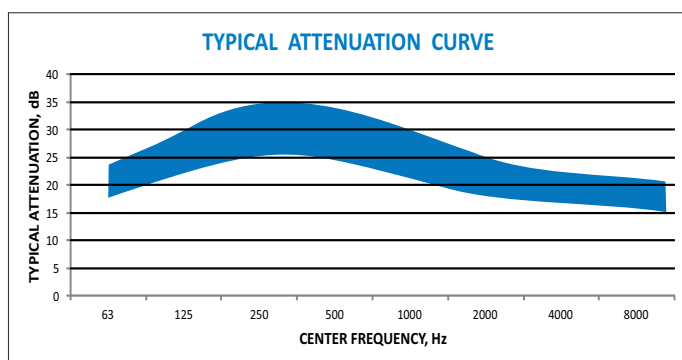

STANDARD CONSTRUCTION

- Dual shell construction to eliminate shell radiated noise and increase durability
- Aluminized/carbon steel construction
- Coated with satin black paint rated to 1200°F
- Connections:
 - Male NPT on 3.5" and smaller
 - 125/150# ANSI flanges on 4" and larger
- Stainless steel and additional inlet/outlet options available Contact factory for details

CUSTOMIZATION

- Chart refers to standard product offering
- Custom configurations, materials, connections, overall dimensions, etc.
- Contact factory with your project's design requirements and specifications

RESIDENTIAL GRADE SILENCER 18-25 dB(A)

This heavy-duty silencer offers practical attenuation for equipment operating in environments where noise levels are moderate.

Applications include commercial, industrial, mining, etc.

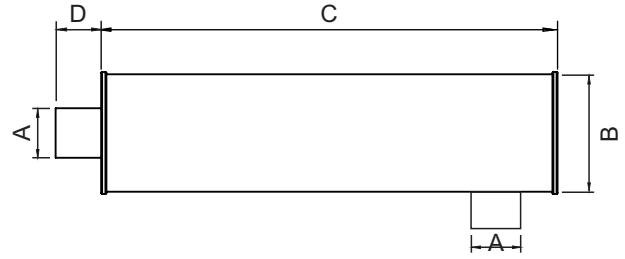
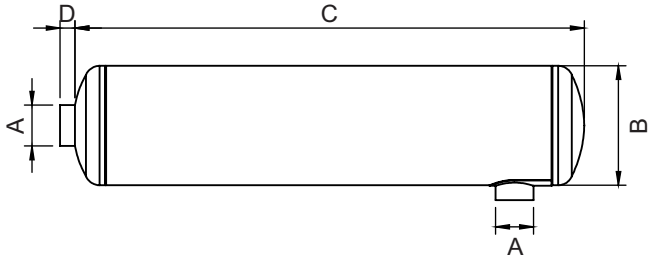

PART NUMBER	COVER TYPE	DIMENSIONS (mm.)				WEIGHT (kg.)
		A	B	C	D	
MJL01-R	STRAIGHT	50,8	200	800	80	
MJL02-R		63,5	200	800	80	
MJL03-R		76,2	250	1000	80	
MJL04-R		88,9	300	1000	80	
MJL05-R		101,6	400	1450	100	
MJL06-R	CAMBERED	127	400	1450	100	
MJL07-R		152,4	500	1700	150	
MJL08-R		203,2	600	2250	150	
MJL09-R		254	800	2800	150	
MJL10-R		304,8	800	2800	150	
MJL11-R		355,6	900	2860	150	
MJL12-R		406,6	900	3350	150	
MJL13-R		457,2	1100	3900	150	
MJL14-R		508	1100	3900	150	

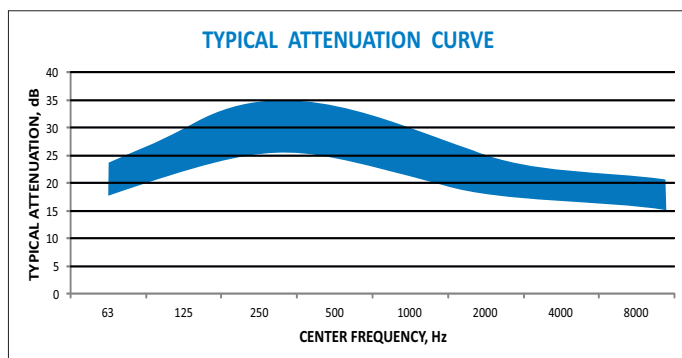

STANDARD CONSTRUCTION

- Dual shell construction to eliminate shell radiated noise and increase durability
- Aluminized/carbon steel construction
- Coated with satin black paint rated to 1200°F
- Connections:
 - Male NPT on 3.5" and smaller
 - 125/150# ANSI flanges on 4" and larger
- Stainless steel and additional inlet/outlet options available Contact factory for details

CUSTOMIZATION

- Chart refers to standard product offering
- Custom configurations, materials, connections, overall dimensions, etc.
- Contact factory with your project's design requirements and specifications

RESIDENTIAL GRADE SILENCER 18-25 dB(A)

This heavy-duty silencer offers practical attenuation for equipment operating in environments where noise levels are moderate.

Applications include commercial, industrial, mining, etc.

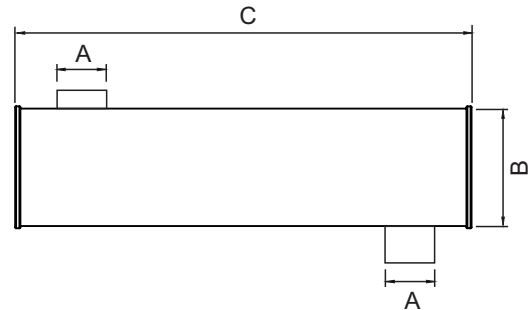
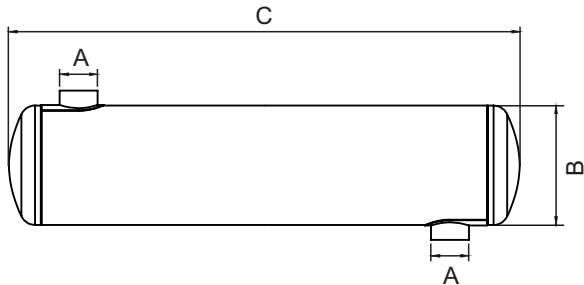

PART NUMBER	COVER TYPE	DIMENSIONS (mm.)				WEIGHT (kg.)
		A	B	C	D	
MJZ01-R	STRAIGHT	50,8	200	800	80	
MJZ02-R		63,5	200	800	80	
MJZ03-R		76,2	250	1000	80	
MJZ04-R		88,9	300	1000	80	
MJZ05-R		101,6	400	1450	100	
MJZ06-R	CAMBERED	127	400	1450	100	
MJZ07-R		152,4	500	1700	150	
MJZ08-R		203,2	600	2250	150	
MJZ09-R		254	800	2800	150	
MJZ10-R		304,8	800	2800	150	
MJZ11-R		355,6	900	2860	150	
MJZ12-R		406,6	900	3350	150	
MJZ13-R		457,2	1100	3900	150	
MJZ14-R		508	1100	3900	150	

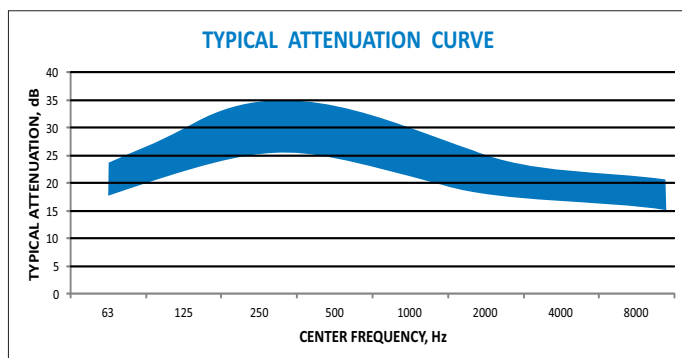

STANDARD CONSTRUCTION

- Dual shell construction to eliminate shell radiated noise and increase durability
- Aluminized/carbon steel construction
- Coated with satin black paint rated to 1200°F
- Connections:
 - Male NPT on 3.5" and smaller
 - 125/150# ANSI flanges on 4" and larger
- Stainless steel and additional inlet/outlet options available Contact factory for details

CUSTOMIZATION

- Chart refers to standard product offering
- Custom configurations, materials, connections, overall dimensions, etc.
- Contact factory with your project's design requirements and specifications

CRITICAL GRADE SILENCER 25-35 dB(A)

Designed for turbocharged engines, this heavy-duty silencer provides practical attenuation while keeping the backpressure to a minimum. It is ideally suited for equipment operating in environments where noise levels are moderate.

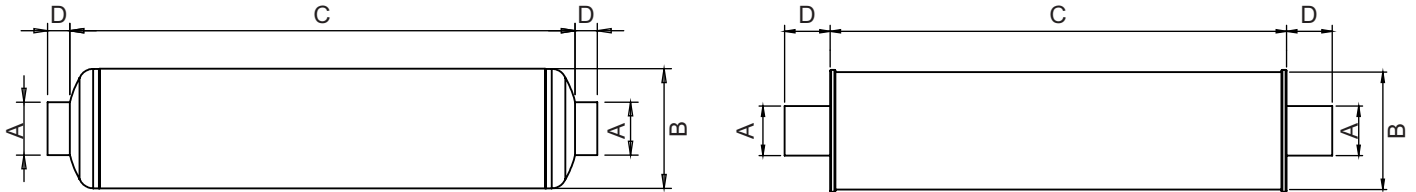

PART NUMBER	COVER TYPE	DIMENSIONS (mm.)				WEIGHT (kg.)
		A	B	C	D	
MJI01-K	STRAIGHT	50,8	200	1000	80	30
MJI02-K		63,5	200	1000	80	35
MJI03-K		76,2	250	1250	80	40
MJI04-K		88,9	300	1250	80	45
MJI05-K	CAMBERED	101,6	400	1500	100	90
MJI06-K		127	400	1500	100	95
MJI07-K		152,4	500	2000	150	150
MJI08-K		203,2	600	2500	150	230
MJI09-K		254	800	3400	150	250
MJI10-K		304,8	800	3400	150	370
MJI11-K		355,6	900	3400	150	450
MJI12-K		406,6	900	4000	150	520
MJI13-K		457,2	1100	4500	150	750
MJI14-K		508	1100	5000	150	770

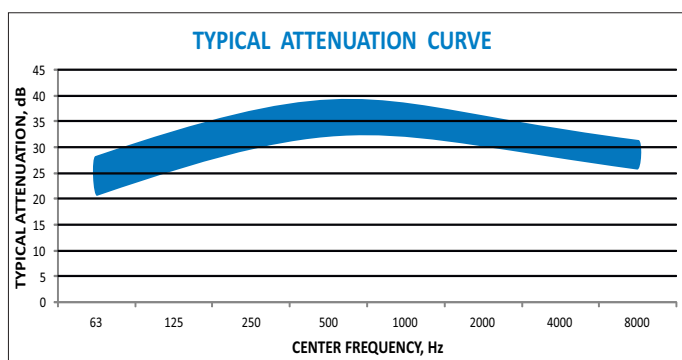

STANDARD CONSTRUCTION

- Dual shell construction to eliminate shell radiated noise and increase durability
- Aluminized/carbon steel construction
- Coated with satin black paint rated to 1200°F
- Connections:
 - Male NPT on 3.5" and smaller
 - 125/150# ANSI flanges on 4" and larger
- Stainless steel and additional inlet/outlet options available – Contact factory for details

CUSTOMIZATION

- Chart refers to standard product offering
- Custom configurations, materials, connections, overall dimensions, etc.
- Contact factory with your project's design requirements and specifications

CRITICAL GRADE SILENCER 25-35 dB(A)

Designed for turbocharged engines, this heavy-duty silencer provides practical attenuation while keeping the backpressure to a minimum. It is ideally suited for equipment operating in environments where noise levels are moderate.

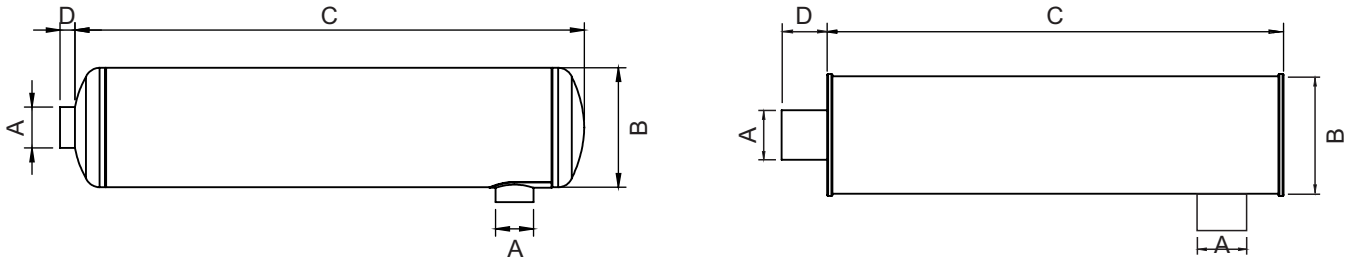

PART NUMBER	COVER TYPE	DIMENSIONS (mm.)				WEIGHT (kg.)
		A	B	C	D	
MJL01-K	STRAIGHT	50,8	200	1000	80	30
MJL02-K		63,5	200	1000	80	35
MJL03-K		76,2	250	1250	80	40
MJL04-K		88,9	300	1250	80	45
MJL05-K	CAMBERED	101,6	400	1500	100	90
MJL06-K		127	400	1500	100	95
MJL07-K		152,4	500	2000	150	150
MJL08-K		203,2	600	2500	150	230
MJL09-K		254	800	3400	150	250
MJL10-K		304,8	800	3400	150	370
MJL11-K		355,6	900	3400	150	450
MJL12-K		406,6	900	4000	150	520
MJL13-K		457,2	1100	4500	150	750
MJL14-K		508	1100	5000	150	770

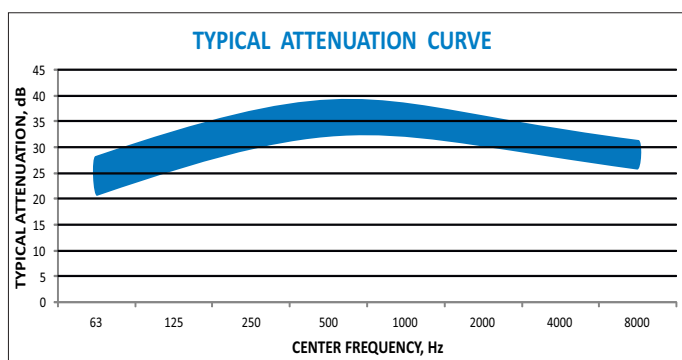

STANDARD CONSTRUCTION

- Dual shell construction to eliminate shell radiated noise and increase durability
- Aluminized/carbon steel construction
- Coated with satin black paint rated to 1200°F
- Connections:
 - Male NPT on 3.5" and smaller
 - 125/150# ANSI flanges on 4" and larger
- Stainless steel and additional inlet/outlet options available – Contact factory for details

CUSTOMIZATION

- Chart refers to standard product offering
- Custom configurations, materials, connections, overall dimensions, etc.
- Contact factory with your project's design requirements and specifications

CRITICAL GRADE SILENCER 25-35 dB(A)

Designed for turbocharged engines, this heavy-duty silencer provides practical attenuation while keeping the backpressure to a minimum. It is ideally suited for equipment operating in environments where noise levels are moderate.

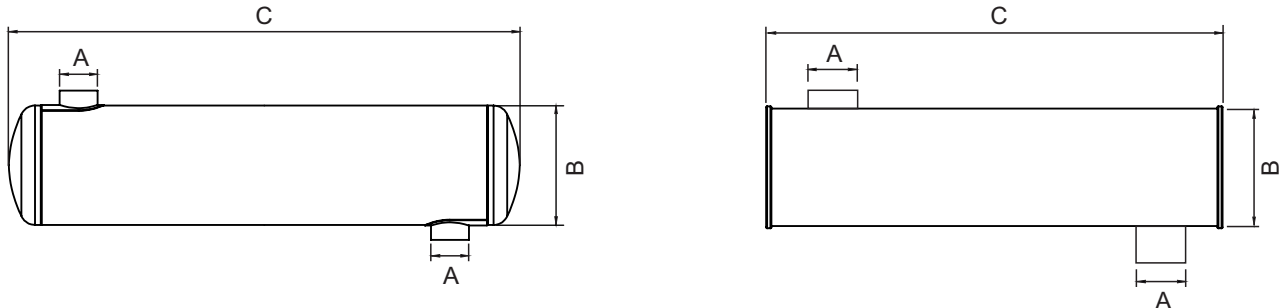

PART NUMBER	COVER TYPE	DIMENSIONS (mm.)				WEIGHT (kg.)
		A	B	C	D	
MJZ01-K	STRAIGHT	50,8	200	1000	80	30
MJZ02-K		63,5	200	1000	80	35
MJZ03-K		76,2	250	1250	80	40
MJZ04-K		88,9	300	1250	80	45
MJZ05-K	CAMBERED	101,6	400	1500	100	90
MJZ06-K		127	400	1500	100	95
MJZ07-K		152,4	500	2000	150	150
MJZ08-K		203,2	600	2500	150	230
MJZ09-K		254	800	3400	150	250
MJZ10-K		304,8	800	3400	150	370
MJZ11-K		355,6	900	3400	150	450
MJZ12-K		406,6	900	4000	150	520
MJZ13-K		457,2	1100	4500	150	750
MJZ14-K		508	1100	5000	150	770

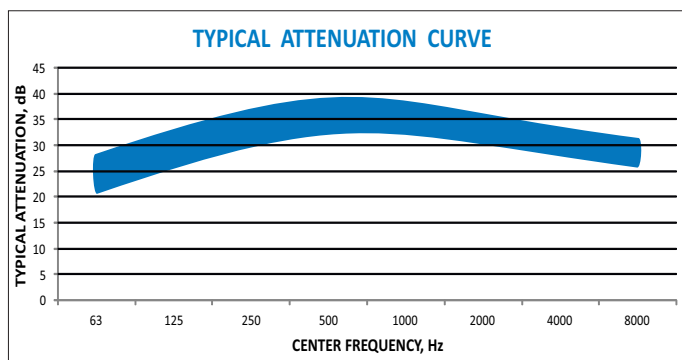

STANDARD CONSTRUCTION

- Dual shell construction to eliminate shell radiated noise and increase durability
- Aluminized/carbon steel construction
- Coated with satin black paint rated to 1200°F
- Connections:
 - Male NPT on 3.5" and smaller
 - 125/150# ANSI flanges on 4" and larger
- Stainless steel and additional inlet/outlet options available – Contact factory for details

CUSTOMIZATION

- Chart refers to standard product offering
- Custom configurations, materials, connections, overall dimensions, etc.
- Contact factory with your project's design requirements and specifications

SPARK ARRESTOR 12-18 dB(A)

The dimensions shown are for informational purposes only.
Please contact us to select the appropriate product for your system and other product sizes

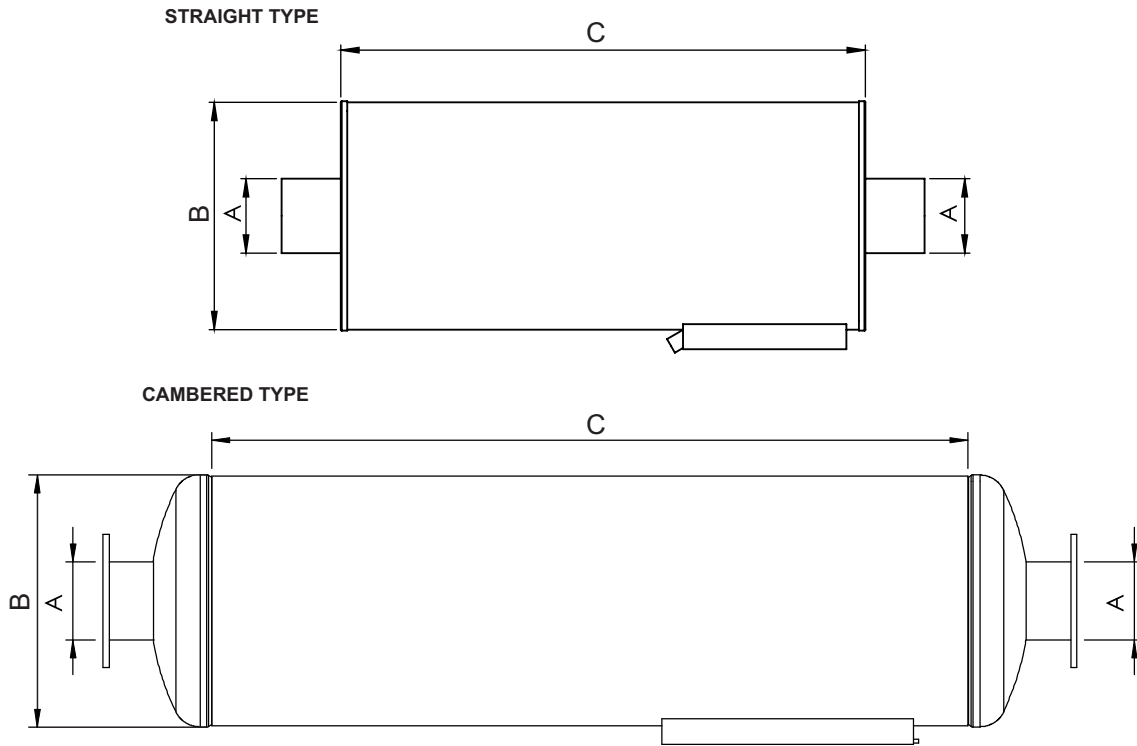

PART NUMBER	PART NUMBER	PART NUMBER	COVER TYPE	DIMENSIONS (mm.)		
				A	B	C
MSP01-E	MJI01-K	MJZ01-K		50,8	200	800
MSP02-E	MJI02-K	MJZ02-K		63,5	200	800
MSP03-E	MJI03-K	MJZ03-K	STRAIGHT	76,2	250	1000
MSP04-E	MJI04-K	MJZ04-K		88,9	300	1000
MSP05-E	MJI05-K	MJZ05-K		101,6	400	1250
MSP06-E	MJI06-K	MJZ06-K		127	400	1250
MSP07-E	MJI07-K	MJZ07-K	CAMBERED	152,4	500	1500
MSP08-E	MJI08-K	MJZ08-K		203,2	600	1700
MSP09-E	MJI09-K	MJZ09-K		254	800	2000

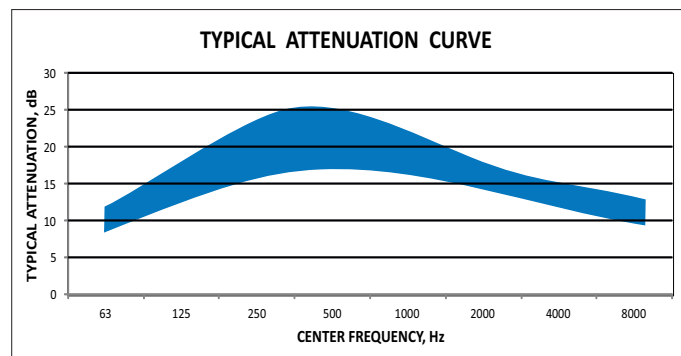

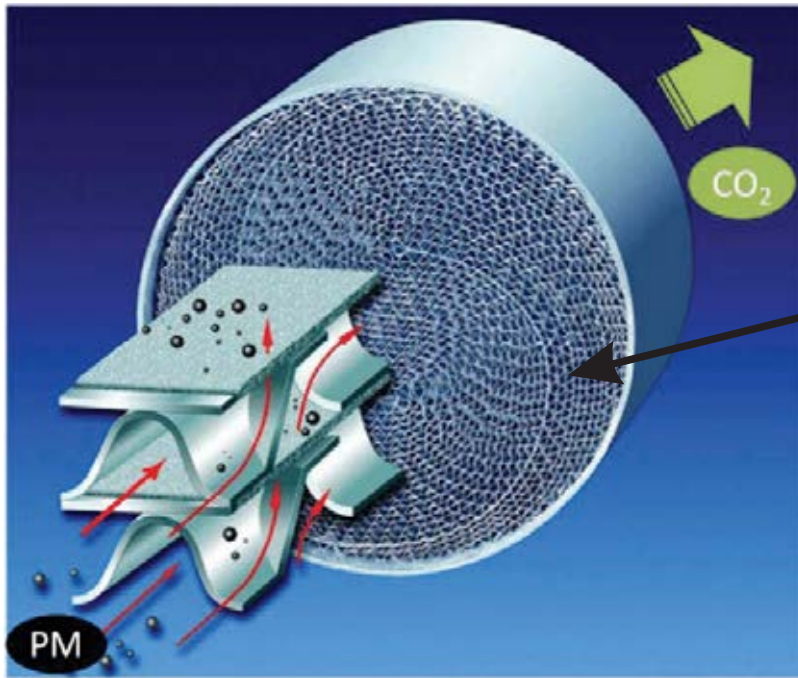

Stainless steel band to provide rigidity and protect operators from foil abrasions

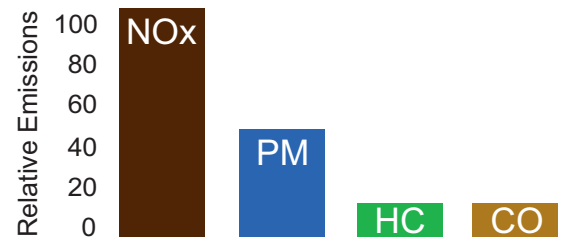

Catalyst Substrate Specifications

The design substrate contains a number of features to make it a very rugged and reliable substrate for small and medium industrial engines. The metal foils are vacuum brazed directly to each other and to the outer shell to prevent telescoping due to gas pulsations and engine vibrations, and to prevent damage due to thermal expansion stress from the high-temperature operation

Brazed high-temperature-resistant steel coils of alternating layers of corrugated and flat strips 100,200,300 or 400 cpsi (cells per square inch)

Catalytic materials coated onto the channel surfaces consist of a refractory inorganic oxide, various substances that act as chemical promoters and stabilizers, and a combination of platinum, palladium, and rhodium.



UNIVERSAL OXIDATION CATALYSTS

Please contact us to select the appropriate product for your system and other product sizes

55099-3" UNIVERSAL OXI-CAT

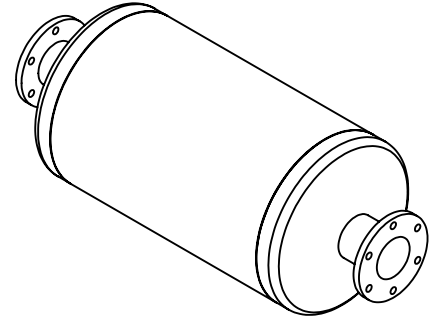
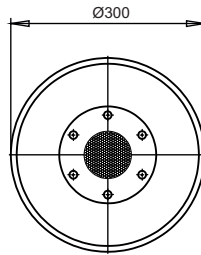
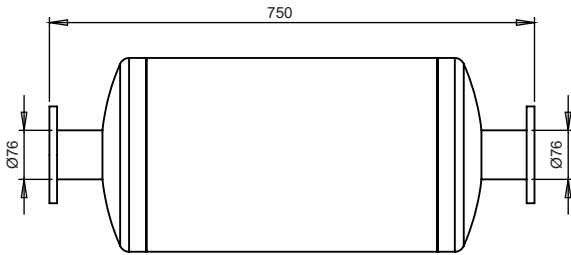

55467-3,5" UNIVERSAL OXI-CAT

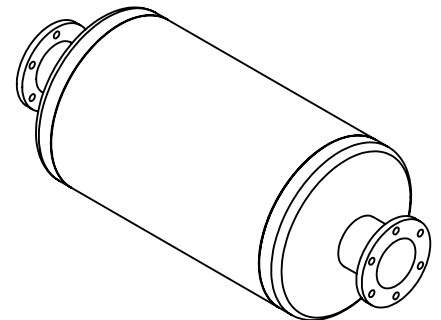
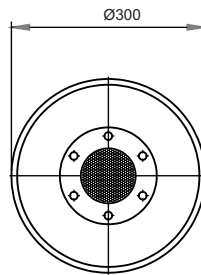
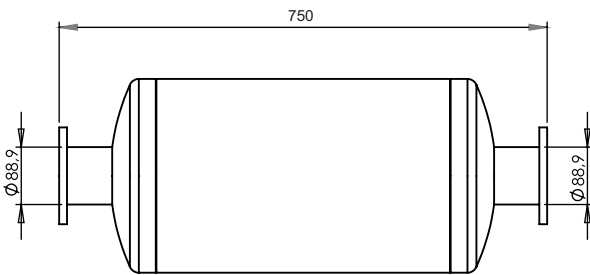

55491-5" UNIVERSAL OXI-CAT

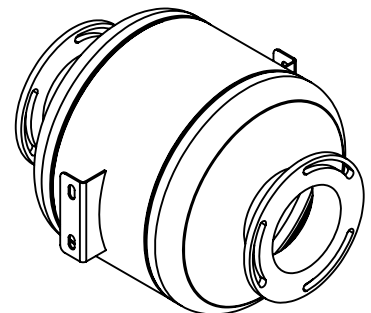
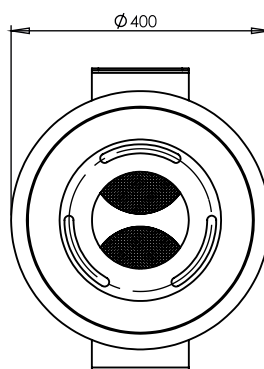
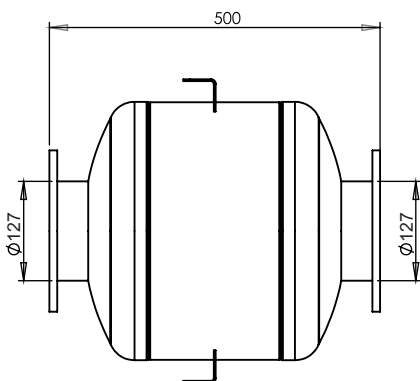

UNIVERSAL OXIDATION CATALYSTS

Please contact us to select the appropriate product for your system and other product sizes

54999-6" UNIVERSAL OXI-CAT

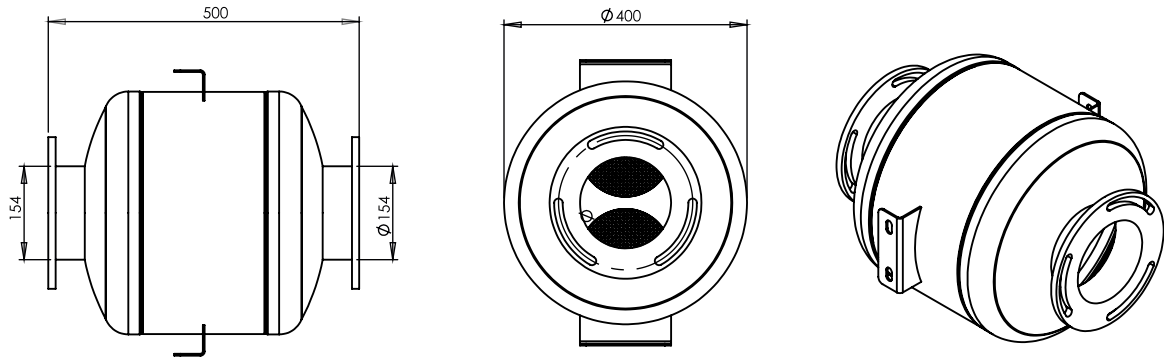

55529-8" UNIVERSAL OXI-CAT

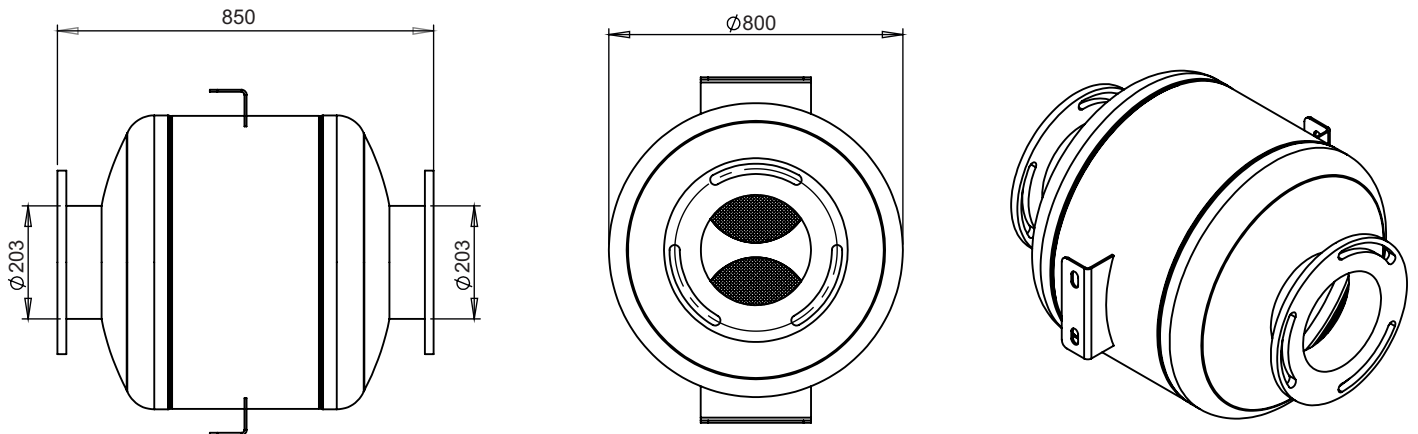

51853-10" UNIVERSAL OXI-CAT

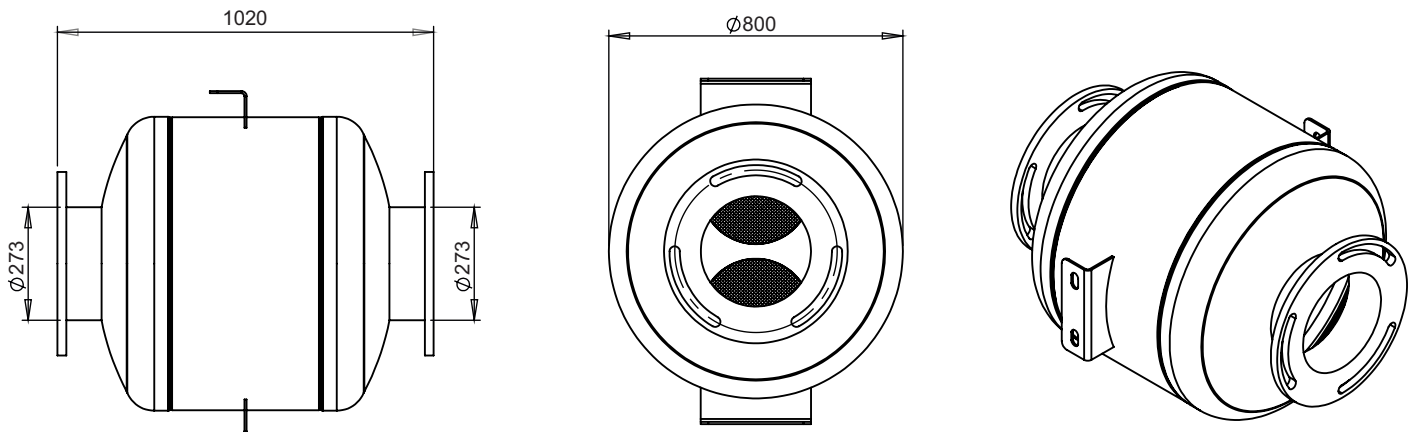

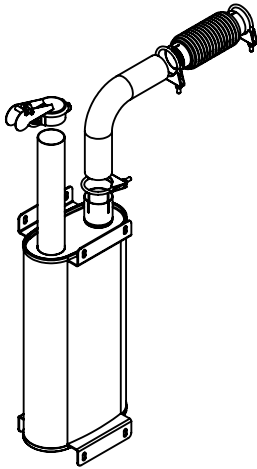

55522 (10-60 KVA)

PART NO.	DESCRIPTION	PCS.
55522-01	MUFFLER	1
55522-02	INLET PIPE	1
54876-01	BELLOWS	1
19940	CLAMP	3
15242	RAIN CAP	1

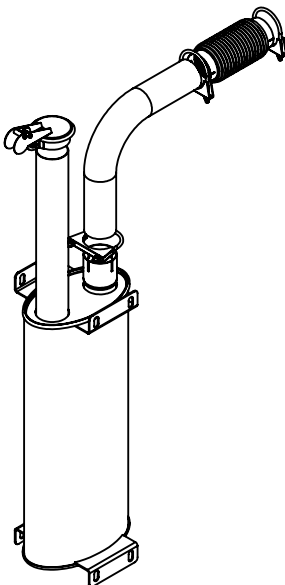

55523 (60-150 KVA)

PART NO.	DESCRIPTION	PCS.
55523-01	MUFFLER	1
55523-02	PIPE	1
54772	BELLOWS	1
19901	CLAMP	3
15204	RAIN CAP	1

Hobi Exhaust Standart Canopy Kits

25 db sound reduction

Tested on Perkins and many other engine types

Very easy to install with brackets welded both sides

You can install left or right side of your canopy

Multiple-use choice provides cost and stock reduction benefits

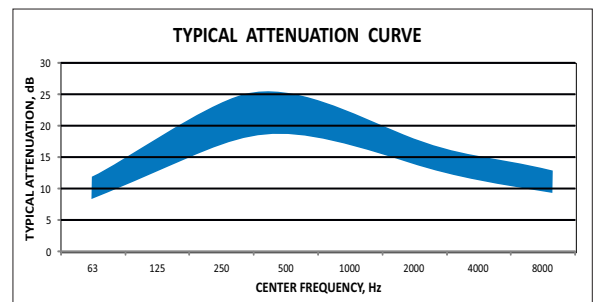

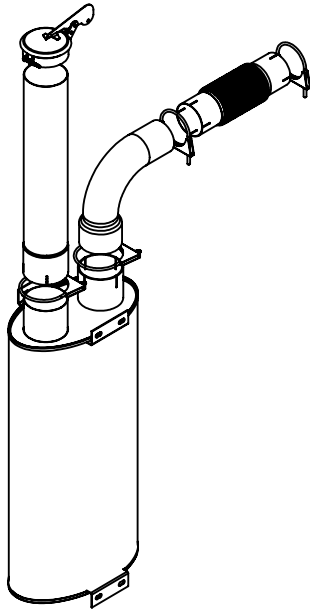

55532 (150-300 KVA)

No.	PART NO.	DESCRIPTION	PCS.
1	55532-01	MUFFLER	1
2	55532-02	OUTLET PIPE	1
3	55532-03	INLET PIPE	1
4	55532-04	BELLOWS	1
5	19871	CLAMP (130)	2
6	19894	CLAMP (105)	2
7	15270	RAIN CAP	1

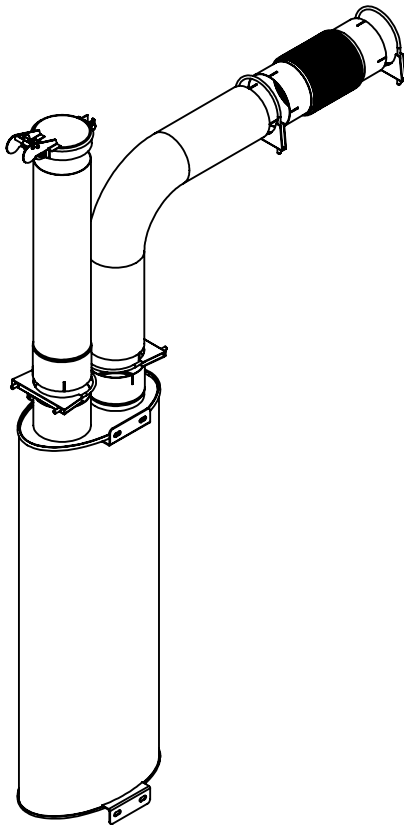

55533 (300-500 KVA)

PART NO.	DESCRIPTION	PCS.
55533-01	MUFFLER	1
55533-02	INLET PIPE	1
55533-03	OUTLET PIPE	1
55533-04	BELLOWS	1
19833	CLAMP	3
15238	RAIN CAP	1

Hobi Exhaust Standart Canopy Kits

25 db sound reduction

Tested on Perkins and many other engine types

Very easy to install with brackets welded both sides

You can install left or right side of your canopy

Multiple-use choice provides cost and stock reduction benefits

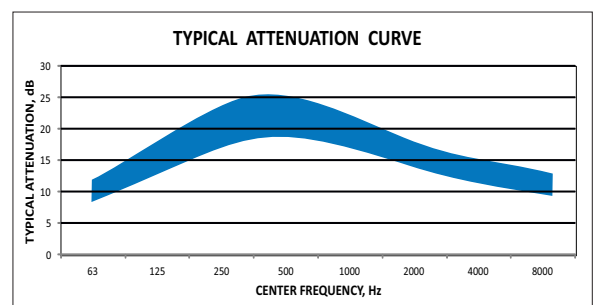

SPECIAL PRODUCTIONS

ENGINE	EXHAUST GAS FLOW (m ³ /min)	EXHAUST GAS TEMPERATURE (°C)	ALLOWABLE BACK PRESSURE (KPA)	CURRENT BACK PRESSURE (KPA)
PERKINS 4006-23TAG2	209	500	6	5,1

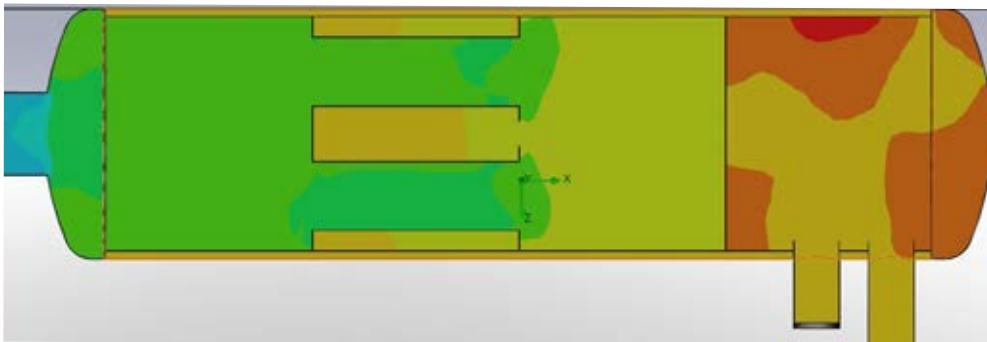
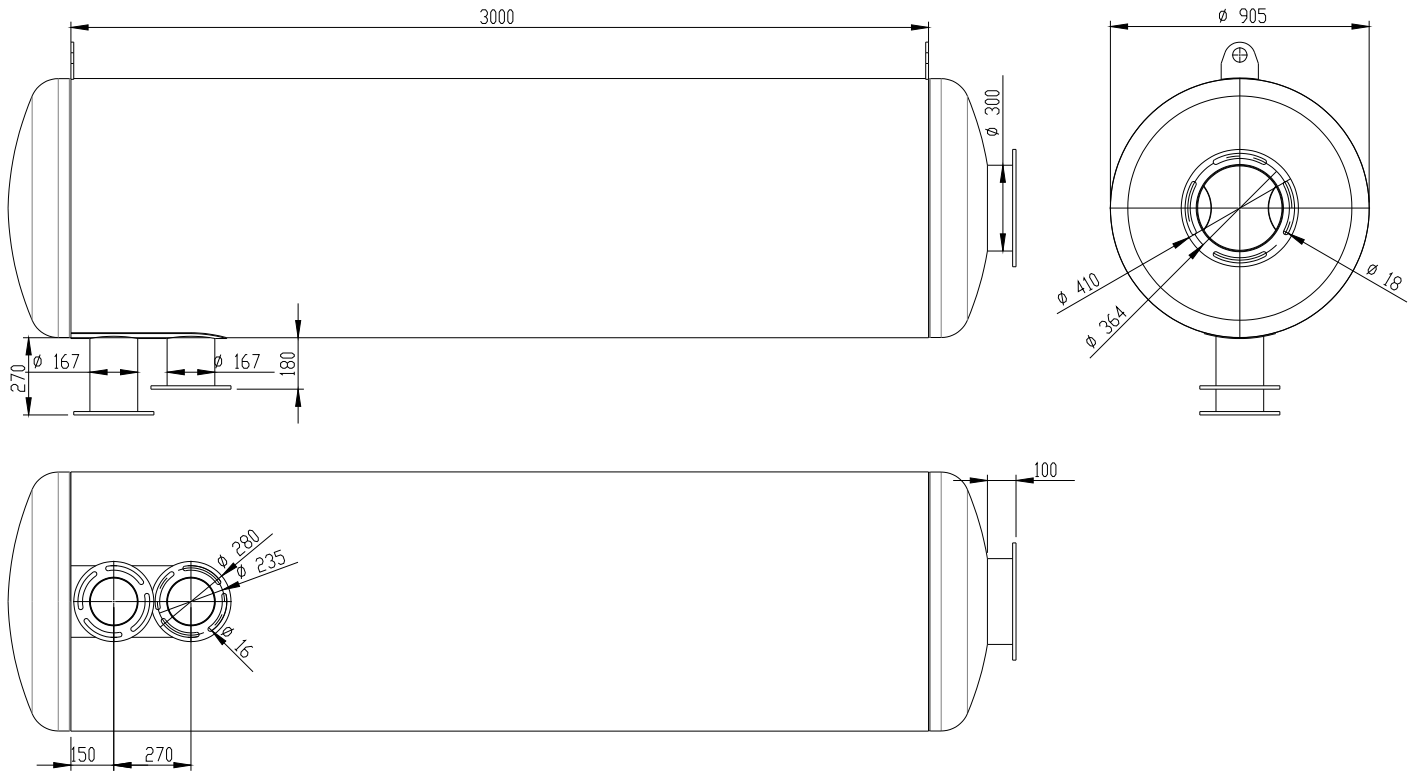

The dimensions shown are for informational purposes only. Please contact us to select the appropriate product for your system and other product sizes

SPECIAL PRODUCTIONS

ENGINE	EXHAUST GAS FLOW (m3/min)	EXHAUST GAS TEMPERATURE (°C)	ALLOWABLE BACK PRESSURE (KPA)	CURRENT BACK PRESSURE (KPA)
CAT C18 ATAAC	142	410	8,5	3,3

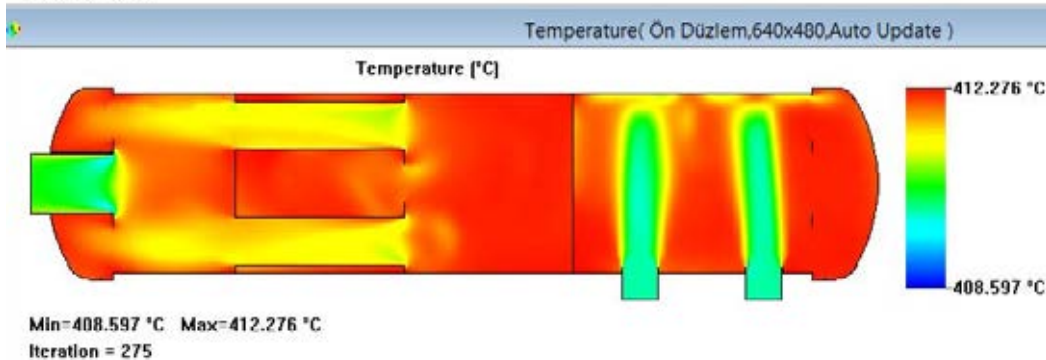
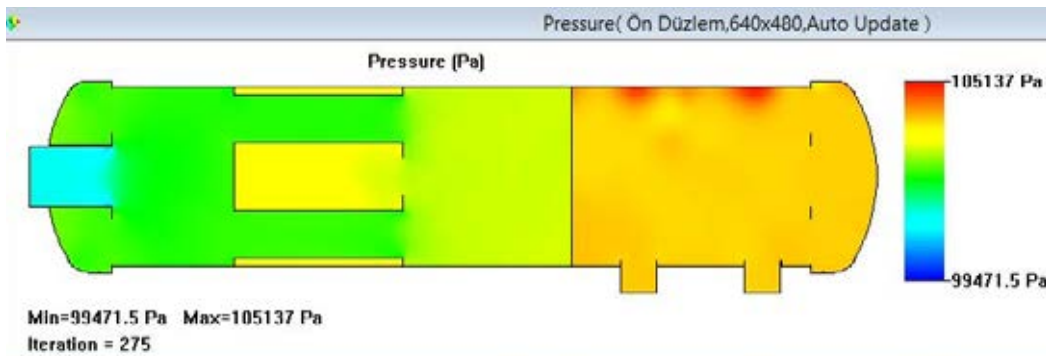
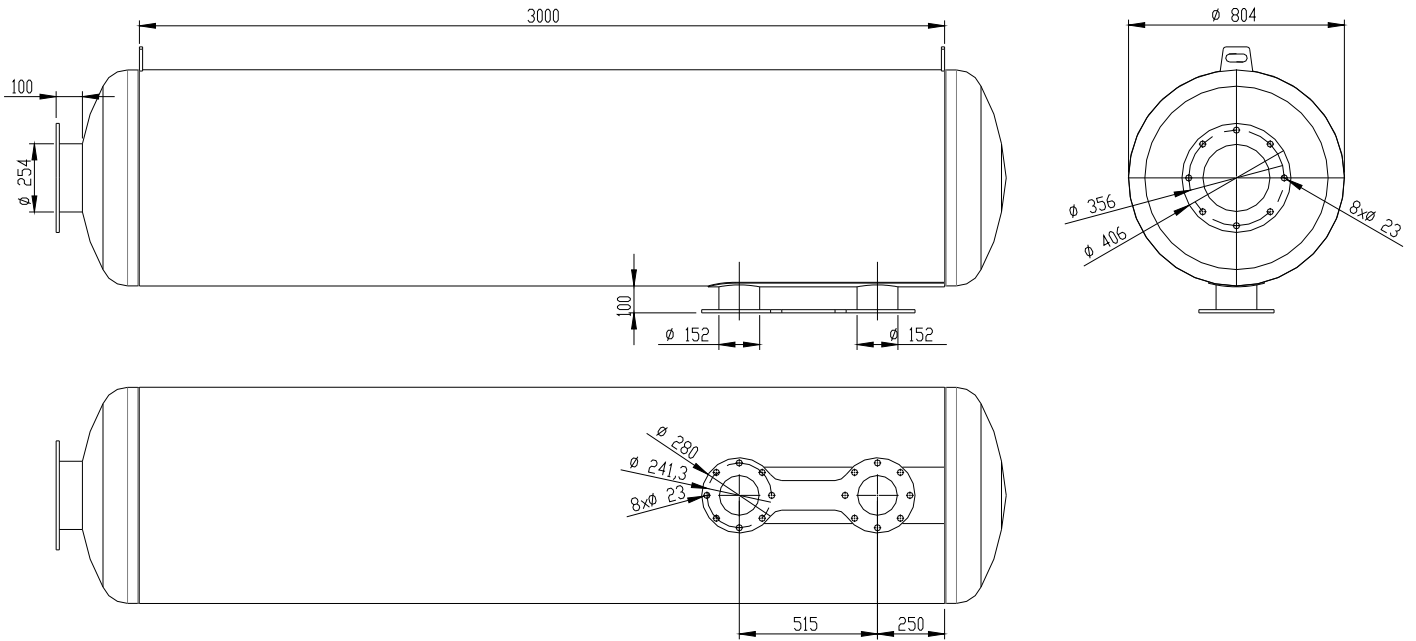

The dimensions shown are for informational purposes only. Please contact us to select the appropriate product for your system and other product sizes

SPECIAL PRODUCTIONS

ENGINE	EXHAUST GAS FLOW (m3/min)	EXHAUST GAS TEMPERATURE (°C)	ALLOWABLE BACK PRESSURE (KPA)	CURRENT BACK PRESSURE (KPA)
CAT C13 ATAAC	62,8	667	10	3

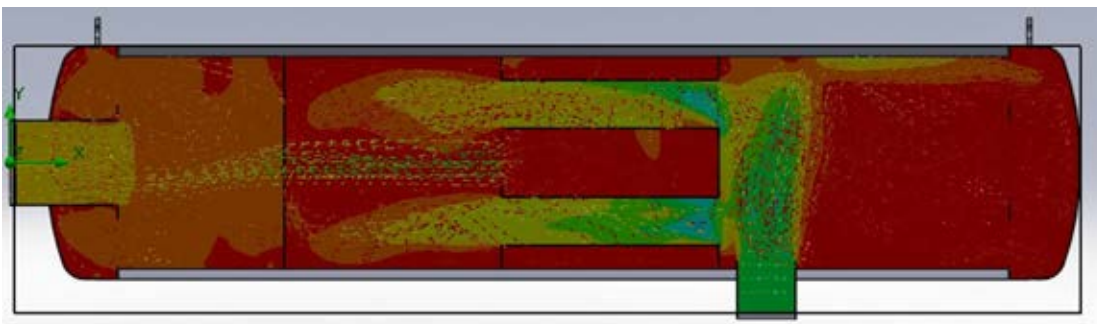
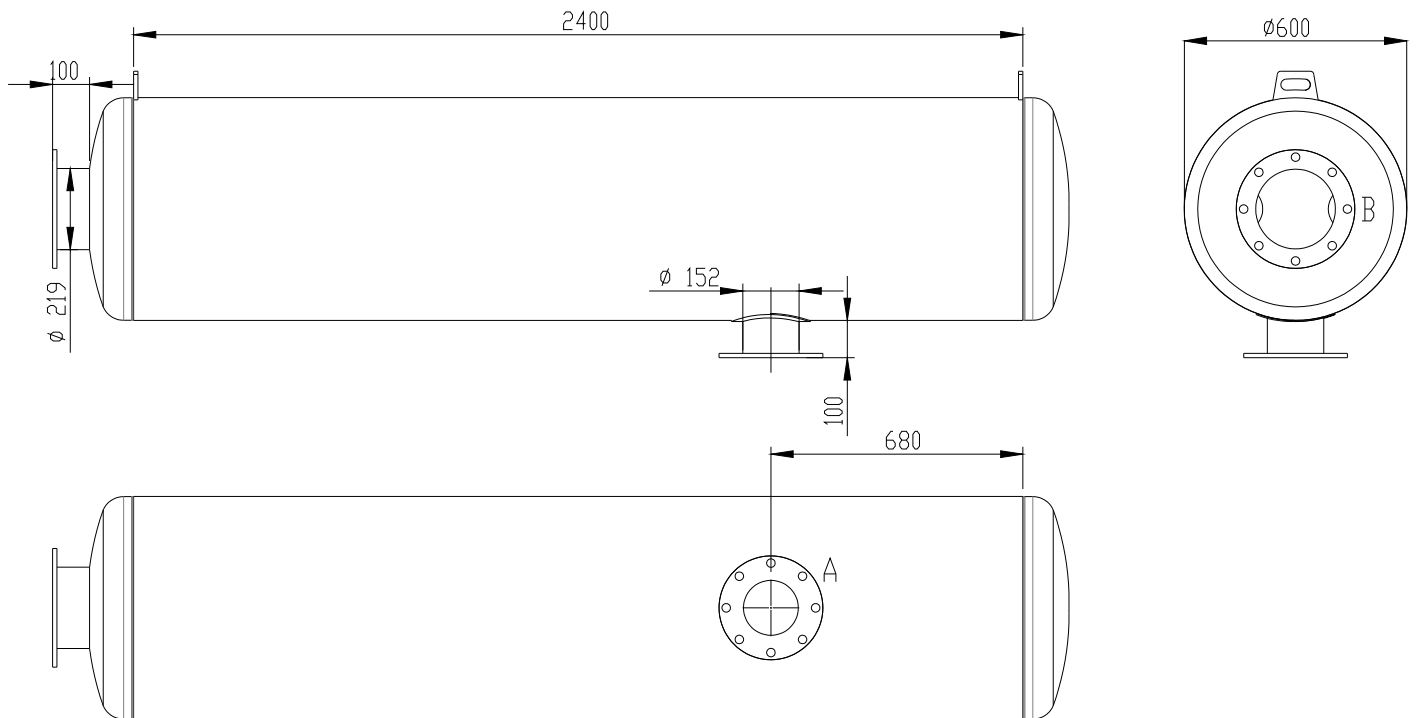

The dimensions shown are for informational purposes only. Please contact us to select the appropriate product for your system and other product sizes

SPECIAL PRODUCTIONS

ENGINE	EXHAUST GAS FLOW (m3/min)	EXHAUST GAS TEMPERATURE (°C)	ALLOWABLE BACK PRESSURE (KPA)	CURRENT BACK PRESSURE (KPA)
BAUDOIN 12M26G1100/5	200,2	550	7,5	2

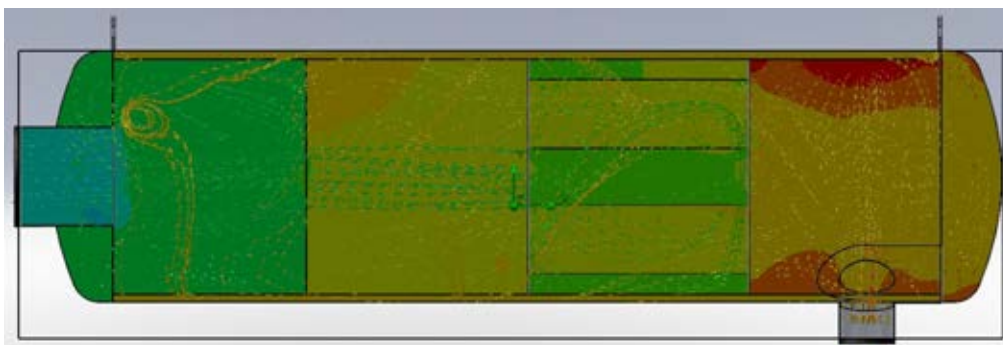
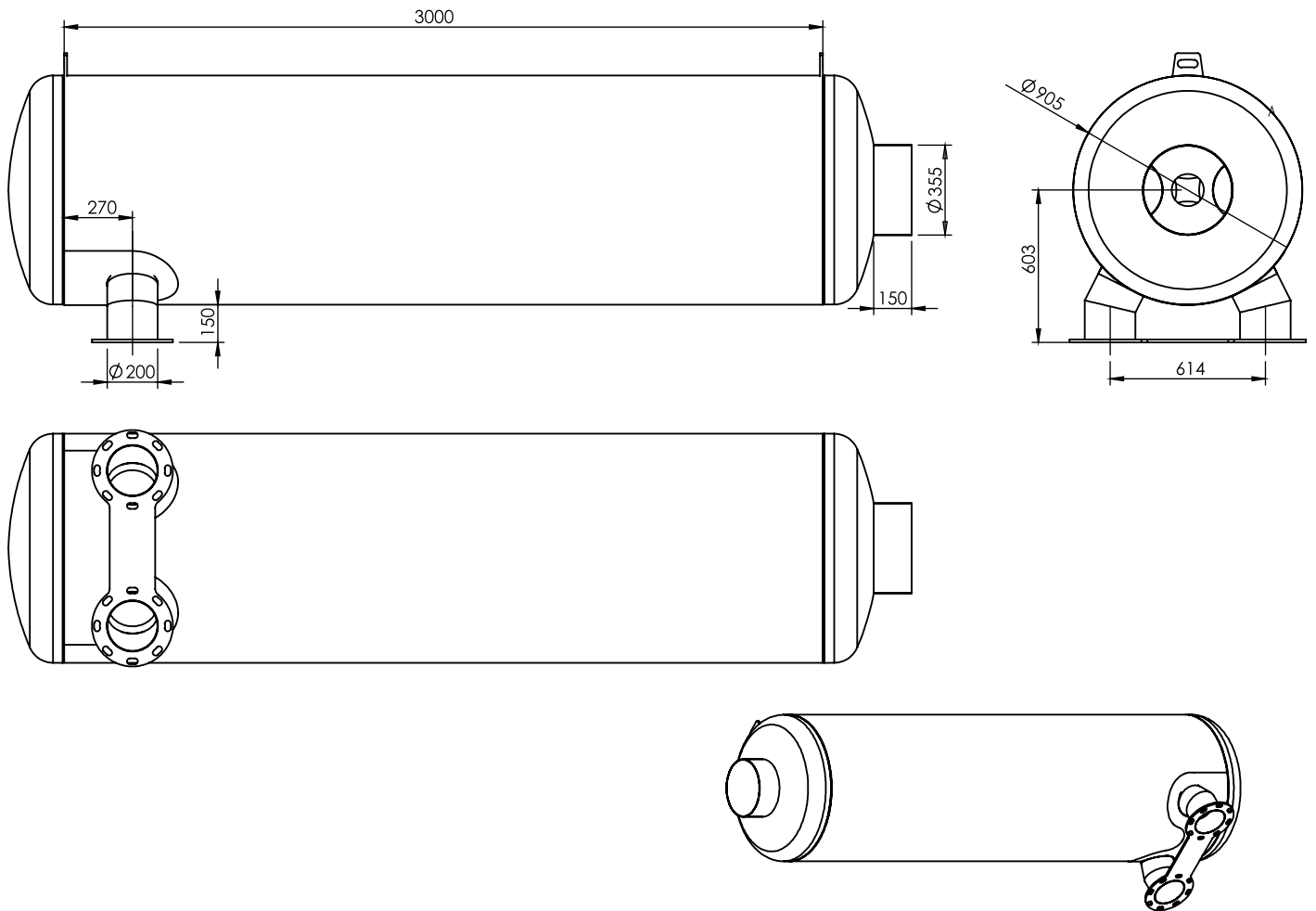

The dimensions shown are for informational purposes only. Please contact us to select the appropriate product for your system and other product sizes

SPECIAL PRODUCTIONS

ENGINE	EXHAUST GAS FLOW (m3/min)	EXHAUST GAS TEMPERATURE (°C)	ALLOWABLE BACK PRESSURE (KPA)	CURRENT BACK PRESSURE (KPA)
BAUDOIN 12M26G1100/5	200,2	550	7,5	7

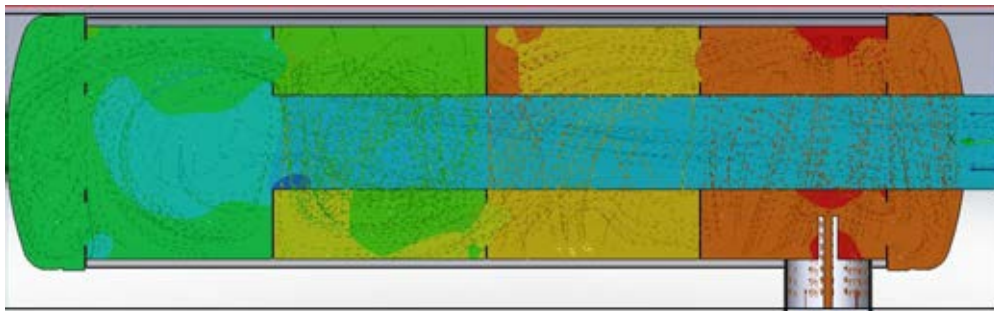
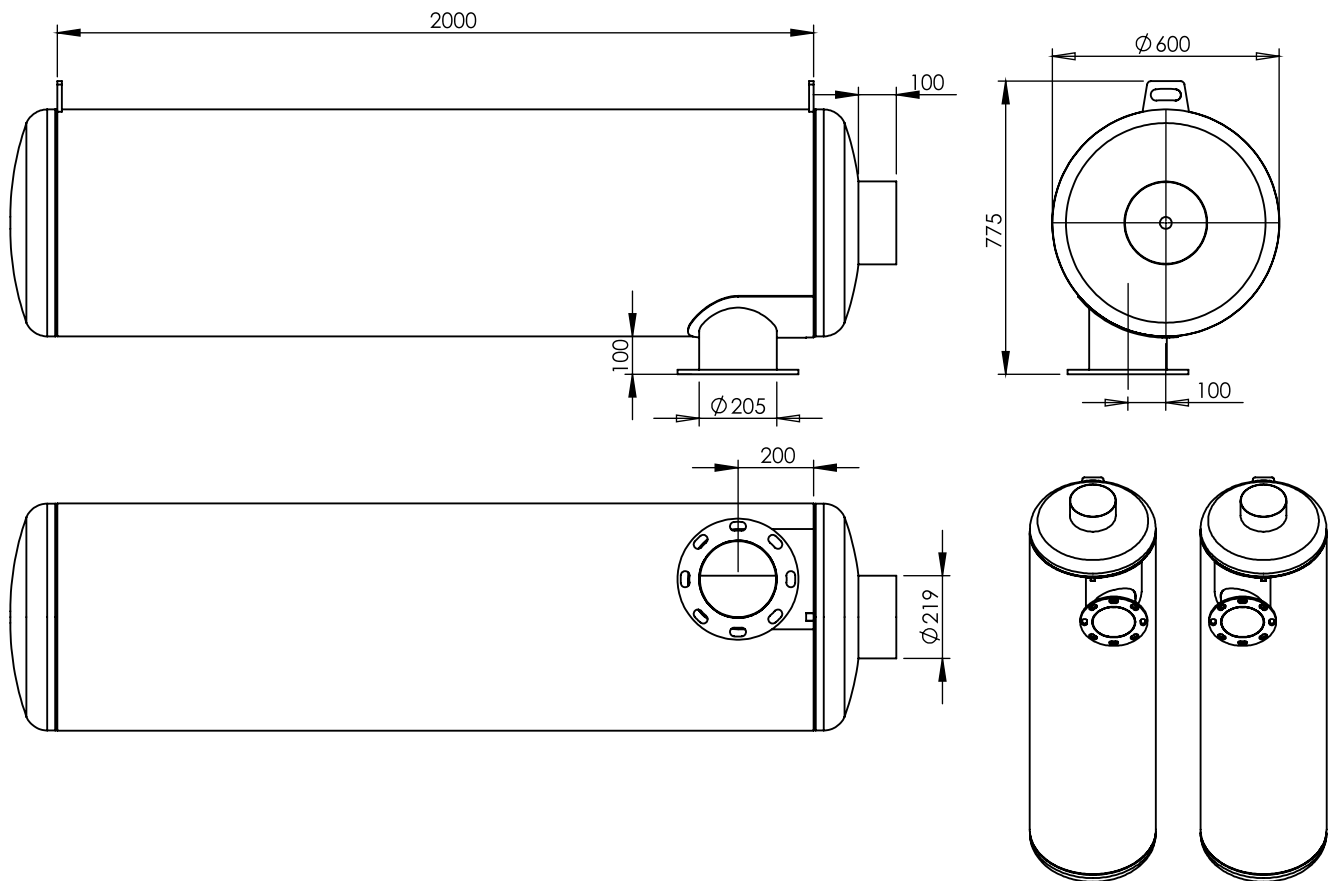

The dimensions shown are for informational purposes only. Please contact us to select the appropriate product for your system and other product sizes

SPECIAL PRODUCTIONS

ENGINE	EXHAUST GAS FLOW kg/h	EXHAUST GAS TEMPERATURE (°C)	ALLOWABLE BACK PRESSURE (KPA)	CURRENT BACK PRESSURE (KPA)
MTU 16V4000GS	11552	500	4	4

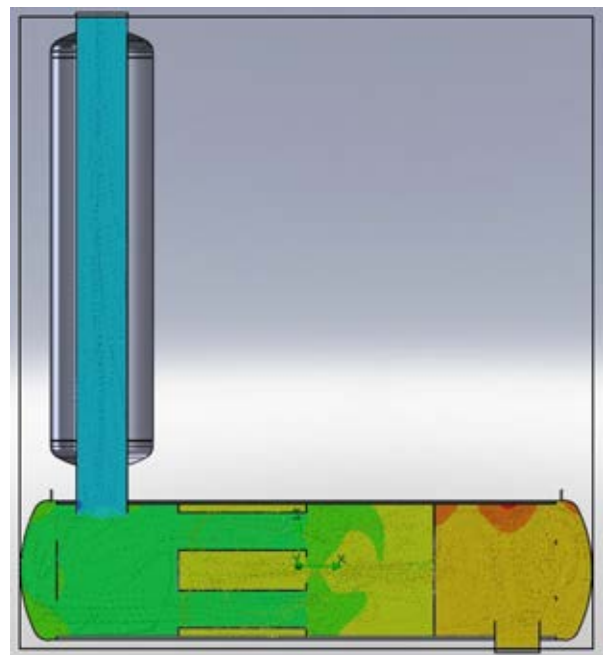
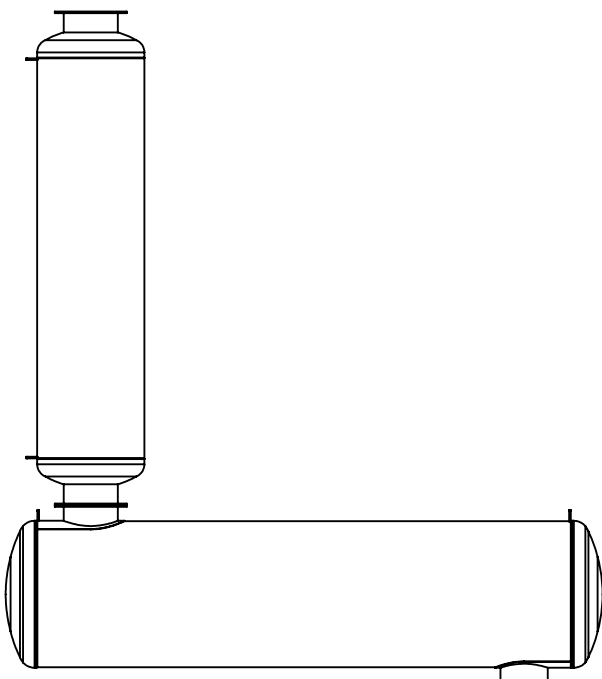
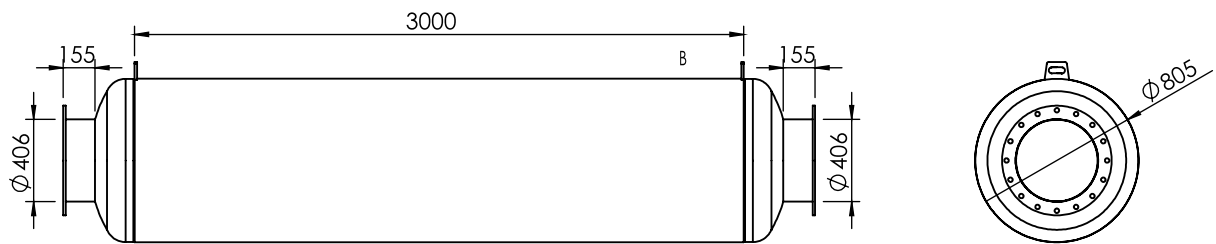
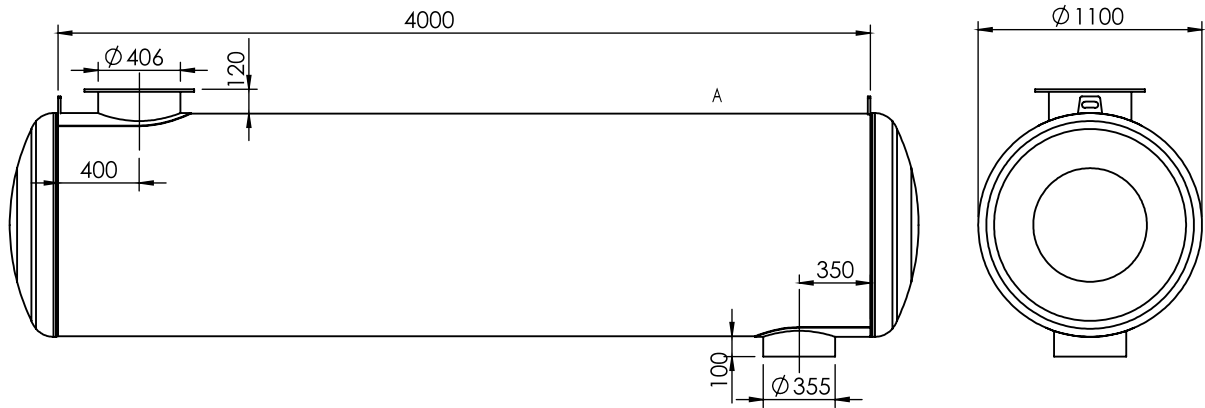

The dimensions shown are for informational purposes only. Please contact us to select the appropriate product for your system and other product sizes

SPECIAL PRODUCTIONS

ENGINE	EXHAUST GAS FLOW kg/h	EXHAUST GAS TEMPERATURE (°C)	ALLOWABLE BACK PRESSURE (KPA)	CURRENT BACK PRESSURE (KPA)
MTU 20V4000L64	13612	500	4	3,8

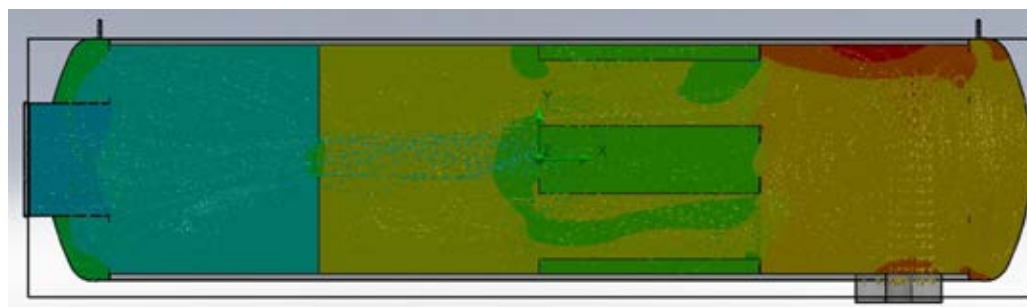
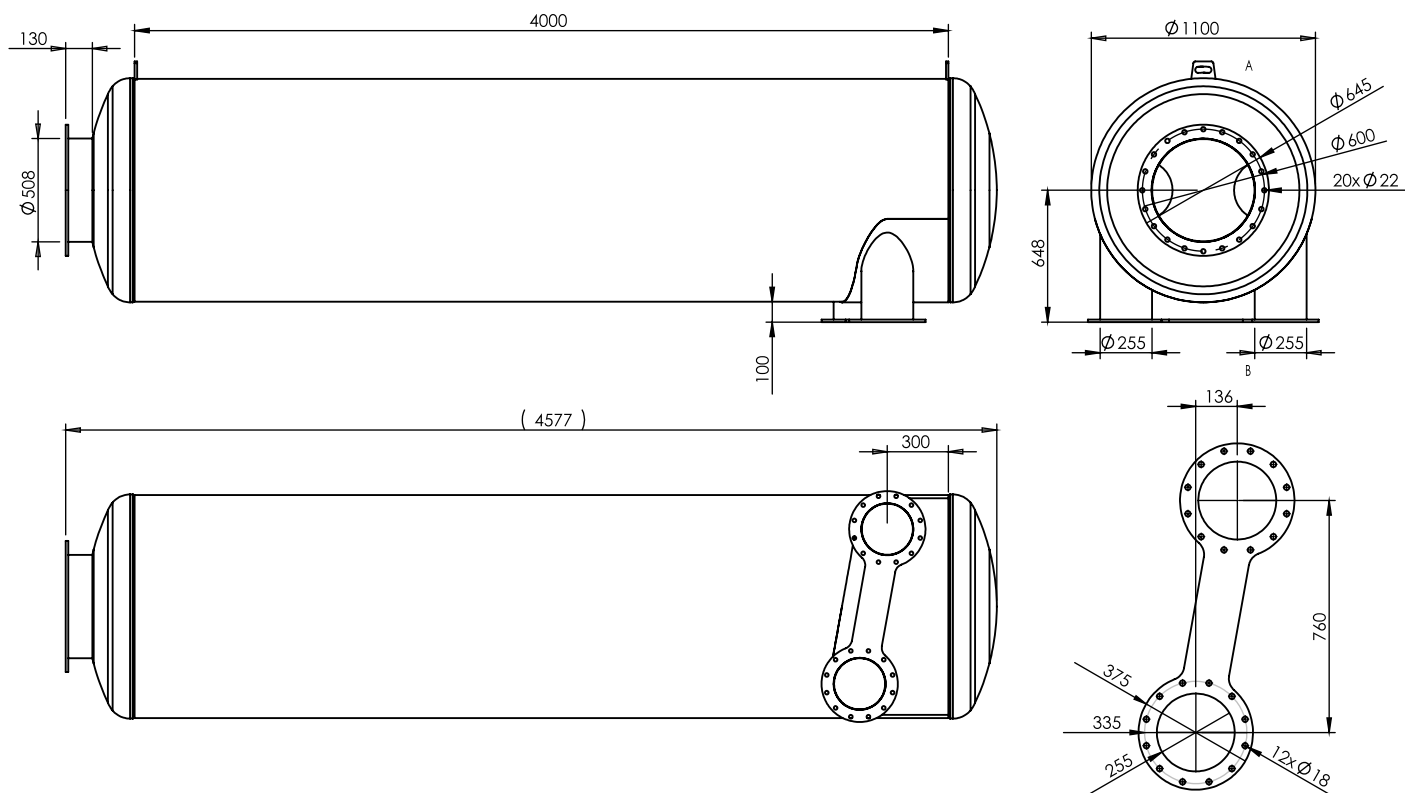

The dimensions shown are for informational purposes only. Please contact us to select the appropriate product for your system and other product sizes

SPECIAL PRODUCTIONS

ENGINE	EXHAUST GAS FLOW (m3/m)	EXHAUST GAS TEMPERATURE (°C)	ALLOWABLE BACK PRESSURE (KPA)	CURRENT BACK PRESSURE (KPA)
	86,3	455	5,9	1,1

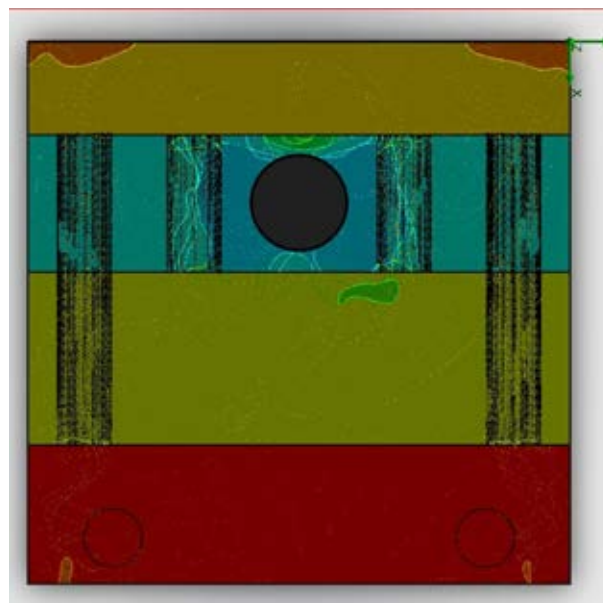
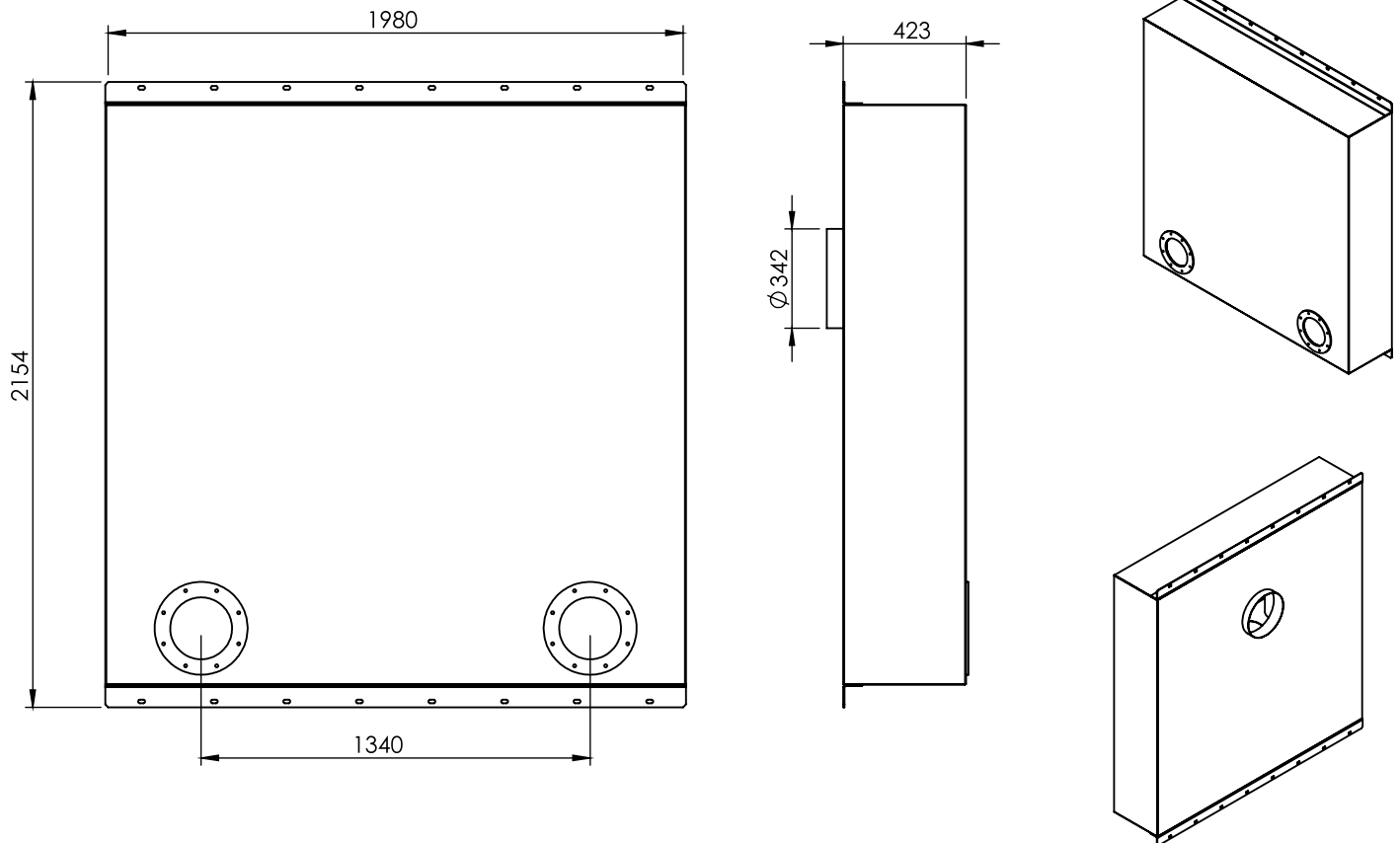

The dimensions shown are for informational purposes only. Please contact us to select the appropriate product for your system and other product sizes

CLAMPS « TORCA »

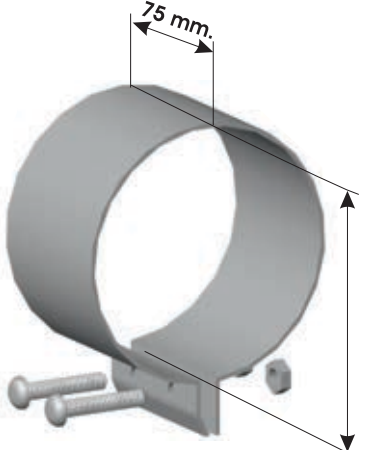
	Galvanized	Inox 304 L	Diameters mm	
	Ref. HOBI	Ref. HOBI	Dia. mm	
	11739	11739T	50	
	11630	11630T	57	
	11646	11646T	63,5	
	11609	11609T	70	
	11604	11604T	76,2	
	11651	11651T	88,9	
	11297	11297T	101,6	
	11295	11295T	108	
	11282	11282T	114,3	
	11270	11270T	127	
	11275	11275T	138	
11233	11233T	152		

Galvanized

CLAMPS « FLEX »

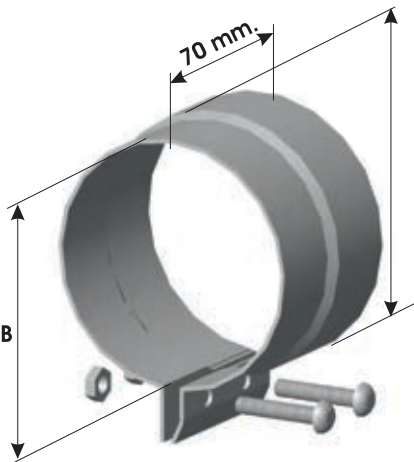
	Galvanized	Inox 304 L	Diameters mm	
	Ref. HOBI	Ref. HOBI	Dia "A"	Dia "B"
	11783	11783T	55	50
	11735	11735T	62	57
	11748	11748T	65	60
	11741	11741T	75	70
	11700	11700T	81,2	76,2
	11758	11758T	84	80
	11719	11719T	93,6	88,9
	11698	11698T	105	100
	11696	11696T	106,6	102,6
	11688	11688T	115	110
	11683-59508	11683T	119	114,3
	11678	11678T	125	120
	11675	11675T	132	128
	11639	11639T	158	152

CLAMPS « CIRCLE »

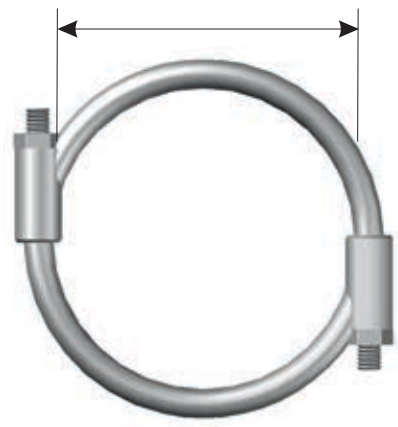
	Galvanized	
	Ref. HOBI	Dia. mm
	11957	76 - 82
	11912	83 - 94
	11890	95 - 107
	11882	108 - 114
	11881	115 - 119
	11867	120 - 132
11832	142 - 154	

CLAMPS « DIN »

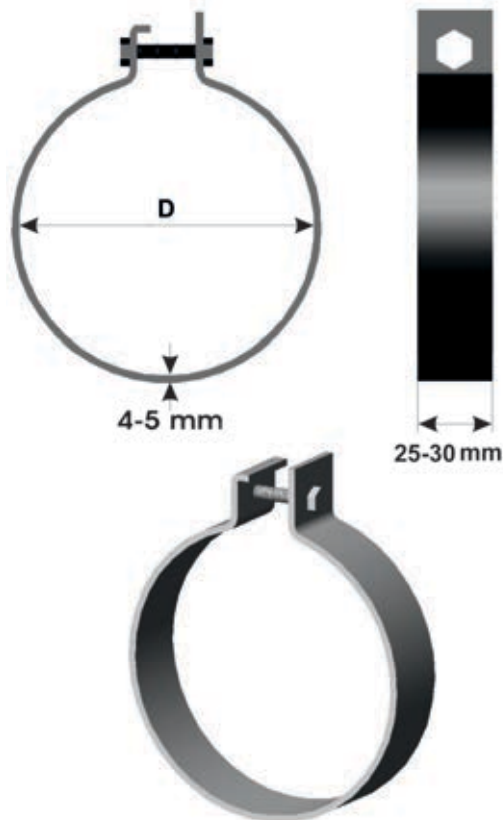

Galvanized

Ref. HOBI	Dia. mm
11023	45,5
11025	48,5
11039	50,5
11036	53,5
11033	55,5
11035	58,5
11049	60,5
11046	63,5
11043	65,5
11045	68,5
11009	70,5
11006	73,5
11003	75,5
11004	76,5
11005	78,5
11059	80,5
11053	85,5
11051	90,5
11012	94,5
11099	100,5
11097	102,5
11092	104,5
11095	108,5
11089	110,5
11082	114,5
11079	120,5
11072	124,5
11070	127,5
11069	130,5

CLAMPS « VOLVO »



Galvanized

Ref. HOBI	Dia. mm
11927	39 - 42
11923	42 - 45
11925	45 - 48
11938	48 - 51
11933	52 - 55
11935	55 - 58
11948	58 - 61
11942	61 - 64
11940	65 - 67
11908	68 - 71
11902	71 - 74
11900	74 - 77
11956	78 - 82
11950	83 - 87
11914 - 42559	91 - 96
11899	100 - 106
11895	104 - 107
11883	108 - 114
11879	115 - 120
11870	123 - 128
11863	130 - 135
11820	142 - 147
11831	151 - 159

CLAMPS « IVECO - MERCEDES »

		Galvanized		
	Design A	Ref. HOBI	Dia. mm	Design
		75589	59,5 - 62,5	A
		75558	63 - 66	A
		75588	65 - 68	A
		75559	67 - 70	A
		39174	74 - 77	A
		39123	76 - 79	A
		75536	80 - 83	A
		39170	87,5 - 90,5	A
		39172	92 - 96	A
		75535	97 - 100	A
		75506	102 - 105	B
		75534	104 - 107	A
		75502	106 - 110	B
		75543	114 - 118	B
		75544	118 - 122	B
		75503	128 - 132	B
		75504	131 - 135	B
		75575	146 - 151	B

RAIN CAP

		Galvanized	
		Ref. HOBI	Dia. mm
		15239	50,5
		15249	60,5
		15242	63,5
		15209	70,5
		15204	76,5
		15259	80,5
		15251	90,0
		15299	100,5
		15297	102,0
		15289	110,5
		15282	115,0
		15279	120,5
		15270	127,5
		15238	152,0
	15245	160 - 168	

EXAMPLES OF ASSEMBLY

FIXING A FLEXIBLE TUBE	SUSPEND A TUBE	FIXING A TUBE ON A CHASSIS
Use the "VOLVO" collars, they do not break the hose coils.	Use the "PLATS" necklaces	USE THE "FLANGES" + "FLANGE SUPPORTS" + "RUBBER"

U-BOLTS « M8 »

		Galvanized			
		Ref. HOBI	Dia. mm	Ref. HOBI	Dia. mm
		19975	29	19909	70
		19967	32	19906	73
		19963	37	19904	76,2
		19965	38	19901	80
		19928	44	19956	83
		19923	45	19951	88,9
		19925	48	19917	92
		19937	52	19913	95,3
		19932	54	19897	102
		19930	57	19894	105
		19949	60	19882	114
		19942	65	19870	127
		19940	67	19871	130

U-BOLTS « M10 »

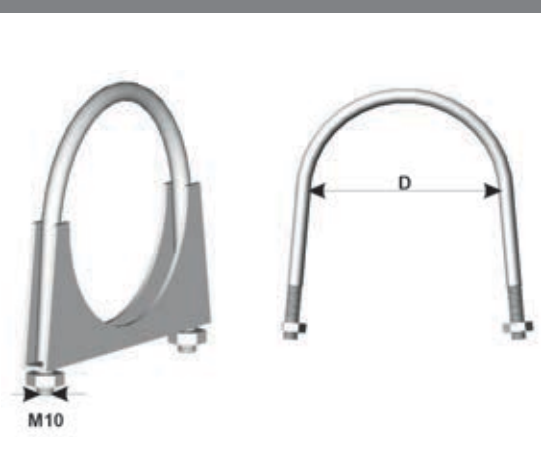
		Galvanized	
		Ref. HOBI	Dia. mm
		19893	105
		19891	109
		19889	110
		19879	120
		19869	130
		19827	142
		19833	155
		19843	165

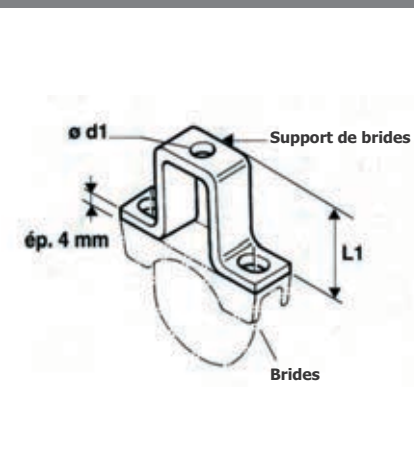

“FLANGE” SUPPORTS

	Pour Tubes	Ref. HOBI	D1	L1	Ref. HOBI
	Dia. Ext mm	Brides	en mm	en mm	
	50	19937	12	49	19997
	60	19949	12	49	19997
	65	19942	12	49	19997
	70	19909	12	49	19998
	75	19904	12	64	19998
	80	19901	12	64	19998
	88,9	19951	12	64	19998
	101,6	19897	14	74	19999
	110	19889	14	74	19999
	120	19879	14	74	19999

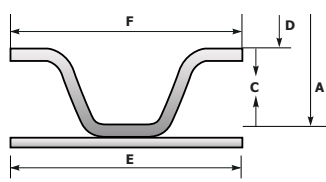

CLAMPS « V »							
Ref. HOBI	Galvanized	Inox 304 L	Dimension mm				
	Ref. HOBI	Ref. HOBI	Dia "A"	Dia "D"	"C"	"E"	"F"
-		44592	73	54	8	18	18
-		55548	82	63,5	4	20	17
-		22593	102	76,1	7	20	23,5
-		05519	113	88,9	7	20	23,5
-		78513	113,0	88,9	11	19	21
-		09592	121	101,6	7	20	23,5
-		05596	125	101,6	5	20	23,5
59189		-	125	101,6	5	20	25
-		28566	124	101,6	4	20	17
-		05583	137	114,3	7	20	23
-		45563	132	114,3	6	20	13,5
-		21161	142	114,3	9	25	18
-		78514	134	114,3	8,5	25	22
71594		-	138	120	7	25	17
-		05575	151	127	7	20	23,5
59178		-	151	127	7	25	18
-		45535	146	127	6	20	13,5
-		78539	151	127	4	20	17
-		78593	150	127	9	25	23
-		75193	159	130	9	25	23

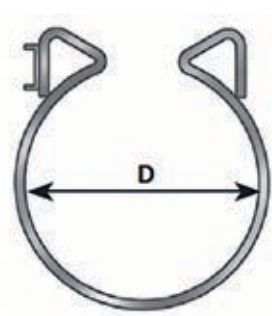

CLAMPS « SCANIA »		
Galvanized		
Ref. HOBI	Dia. mm	Ref. SCANIA
45585	114 - 119	328928 - 1384745
45581	119 - 124	1300367

42180 WELDING FITTINGS				
Galvanized				
Ref. HOBI Clamp	Ref. HOBI Male Part	Dia. Int mm	Ref. HOBI Female Part	Dia. Int mm
42180	43115	108	43111	108

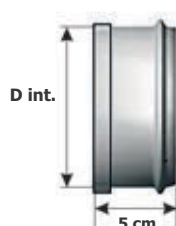
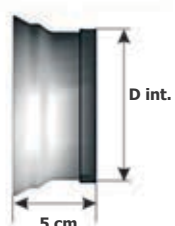



90 ° ELBOWS FEMALE - MALE

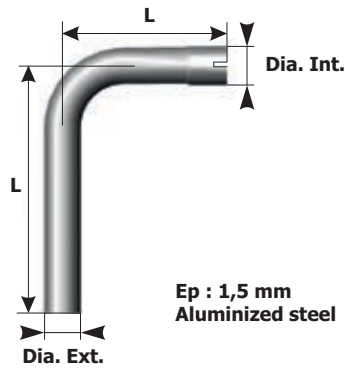

Ref. HOBI	L : en mm	Dia. Int mm	Dia. Ext mm
18938	195	51,30	50,00
18930	240	57,60	57,10
18949	240	60,50	60,00
18942	265	64,00	63,50
18944	265	65,50	65,00
18909	270	70,30	70,00
18902	290	75,50	75,00
18904	295	76,70	76,20
18951	320	89,40	88,90
18897	380	102,10	101,60
18895	400	108,50	108,00
18889	400	110,50	110,00
18882	390	114,80	114,30
18878	410	121,00	120,00
18875	415	128,00	127,00
18827	375	141,00	140,00

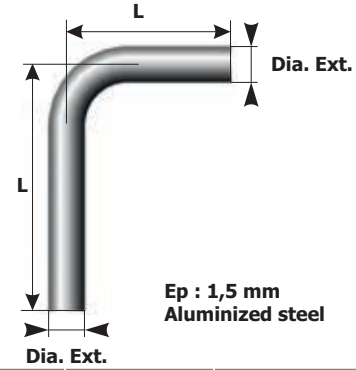
90 ° ELBOWS MALE - MALE



Ref. HOBI	L : en mm	Dia. Ext mm
18939	190	50,00
18934	240	57,10
18931	240	60,00
18946	265	63,50
18943	265	65,00
18908	270	70,00
18906	290	75,00
18903	295	76,20
18959	205	80,00
18955	320	88,90
18899	380	100,00
18898	380	101,60
18891	400	110,00
18886	390	114,30
18879	410	120,00
18870	415	127,00
18829	375	140,00

45 ° ELBOWS FEMALE - MALE



Ref. HOBI	L : en mm	Dia. Int mm	Dia. Ext mm
17938	140	51,30	50,00
17930	150	57,60	57,10
17949	150	60,50	60,00
17942	180	64,00	63,50
17944	180	65,50	65,00
17909	205	70,30	70,00
17902	230	75,50	75,00
17904	205	76,70	76,20
17951	225	89,40	88,90
17897	245	102,10	101,60
17895	260	108,50	108,00
17889	260	110,50	110,00
17882	260	114,80	114,30
17878	365	121,00	120,00
17875	365	128,00	127,00
17829	423	141,50	140,00

45 ° ELBOWS MALE - MALE

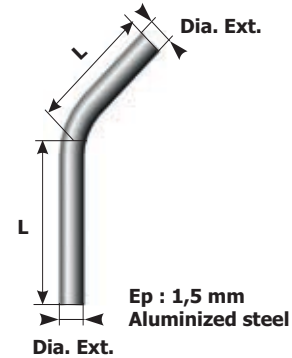

Ref. HOBI	L : en mm	Dia. Ext mm
17939	140	50,00
17934	150	57,10
17931	150	60,00
17947	180	63,50
17943	180	65,00
17908	205	70,00
17903	230	76,20
17959	230	80,00
17955	225	88,90
17899	245	100,00
17898	245	101,60
17891	260	110,00
17886	260	114,30
17879	365	120,00
17870	365	127,00
17828	423	140,00

TUBES MALE - MALE

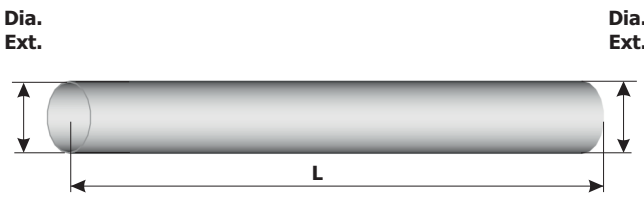
	Ref. HOBI	L : en m	Dia. Ext mm
	<p>Ep : 1,5 mm Aluminized steel</p>	16039	2
16648		2	60,00
16642		2	63,50
16644		2	65,00
16608		2	70,00
12002		2	75,00
12003		2	76,00
12059		2	80,00
12019		2	88,90
12099		2	100,00
12096		2	101,60
12089		2	110,00
12083		2	114,30
12079		2	120,00
12070		2	127,00
12029		2	140,00
12039		2	150,00

FLEXIBLE TUBES 2 METERS

Sold by 2 meter length
For the outer diameter add 4 mm inner diameter

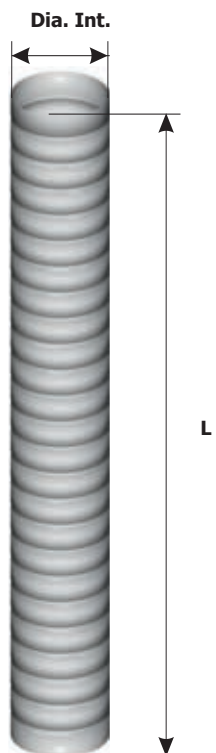
	Flex. INOX		Flex. GALVANIZED	
	Ref. HOBI	Dia. Int mm	Ref. HOBI	Dia. Int mm
<p>L = length of compressed tube</p>	12773	25,00	13773	25,00
	-	30,00	13775	30,00
	12767	32,00	13767	32,00
	-	36,00	13763	36,00
	12765	39,00	13765	39,00
	12728	42,00	13728	42,00
	12722	45,00	13722	45,00
	-	48,00	13725	48,00
	12738	51,00	13738	51,00
	12732	54,50	13732	54,50
	12730	58,00	13730	58,00
	12749	61,00	13749	61,00
	12742	64,00	13742	64,00
	12743	66,00	-	66,00
	12709	70,00	13709	70,00
	12704	77,00	13704	77,00
	12759	80,00	13759	80,00
	-	83,00	13756	83,00
	12753	86,00	13753	86,00
	12751	90,00	13751	90,00
	-	95,00	13713	95,00
	12799	101,00	13799	101,00
	12797	103,00	13797	103,00
	12792	104,00	13792	104,00
	12795	108,00	13795	108,00
	12789	111,00	13789	111,00
	12782	115,00	13782	115,00
	12779	121,50	13779	121,50
	12774	126,50	13774	126,50
	12770	128,00	13770	128,00
12768	131,50	13768	131,50	
12729	141,00	13729	141,00	
12737	153,50	13737	153,50	

Note: A flexible hose is flexible (neither stretched nor compressed).

TUBES MALE - FEMELLE				
<p>Dia. Ext.</p> <p>Dia. Int.</p> <p>L</p> <p>Ep : 1,5 mm Aluminized steel</p>	Ref. HOBI	L : en m	Dia. Ext mm	Dia. Int. mm
	16838	1,5	51,30	50,00
	16830	1,5	57,60	57,10
	16849	1,5	60,50	60,00
	16842	1,5	64,00	63,50
	16809	1,5	70,30	69,80
	16804	1,5	76,70	76,20
	16851	1,5	89,40	88,90
	16897	1,5	102,10	101,60
	16895	1,5	108,50	108,00
	16889	1,5	111,00	110,00
	16882	1,5	114,80	114,30
	16879	1,5	121,00	120,00
	16870	1,5	128,00	127,00

FLEXIBLE TUBES 1 METER				
Sold by 1 meter length For the outer diameter add 4 mm inner diameter				
<p>Dia. Int.</p> <p>L</p> <p>L = length of compressed tube</p>	Flex. INOX		Flex. ÉLECTROZINGUÉS	
	Ref. HOBI	Dia. Int mm	Ref. HOBI	Dia. Int mm
	12873	25,00	13873	25,00
	-	30,00	13875	30,00
	12867	32,00	13867	32,00
	12863	36,00	13863	36,00
	12865	39,00	13865	39,00
	12828	42,00	13828	42,00
	12822	45,00	13822	45,00
	12825	48,00	13825	48,00
	12838	51,00	13838	51,00
	-	54,50	13832	54,50
	12830	58,00	13830	58,00
	12849	61,00	13849	61,00
	12842	64,00	13842	64,00
	12840	67,00	-	67,00
	12809	70,00	13809	70,00
	12804	77,00	13804	77,00
	12859	80,00	13859	80,00
	-	83,00	13856	83,00
	12853	86,00	13853	86,00
	12851	90,00	13851	90,00
	-	95,00	13813	95,00
	12898	101,00	13898	101,00
	12897	103,00	13897	103,00
	12892	104,00	13892	104,00
	12895	108,00	13895	108,00
	12889	111,00	13889	111,00
12882	115,00	13882	115,00	
12879	121,00	13879	121,50	
12874	126,50	13874	126,50	
12870	128,00	13870	128,00	
12868	131,50	13868	131,50	
12829	141,00	13829	141,00	
12837	153,50	13837	153,50	

Note: A flexible hose is flexible (neither stretched nor compressed).

ELBOW TUBES



Ep : 1,5 mm
Aluminized steel

Ref. HOBI	L : en mm	Dia. int mm
18239	260	50,50
18249	305	60,50
18243	1500	65,50
18209	300	70,50
18203	365	75,50
51411	1130	76,00
18259	340	80,50
18218	360	90,50
18298	375	101,00
18287	535	111,00
59443	535	115,00
18278	515	121,00
18268	500	128,00

SLEEVES COUPLINGS Dia Int./Int.

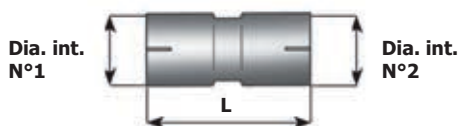

Ref. HOBI	Dia N°1 mm	Dia N°2 mm	L : en mm
16037	51,0	51,0	200
16038	51,0	60,5	200
16049	60,5	64,0	200
16048	60,5	70,5	200
16047	60,5	76,7	200
16031	61,0	61,0	200
16042	64,5	70,8	200
16043	66,0	66,0	200
16009	70,5	76,7	200
16008	71,0	71,0	200
16002	75,5	90,5	200
16006	76,0	76,0	250
16004	76,7	89,5	200
16000	76,7	102,1	200
16058	77,0	77,0	250
16059	80,5	89,5	200
16007	80,5	102,1	200
16001	81,0	81,0	250
16051	89,4	102,1	200
16018	89,4	108,5	200
16017	89,4	110,5	200
16016	89,4	114,8	200
16055	90,0	90,0	250
16012	90,5	114,8	200
16052	101,0	101,0	300
16011	101,0	103,0	200
16099	101,0	114,8	200
16097	102,1	109,0	200
16092	102,1	110,5	200
16086	102,1	114,8	200
16093	102,1	127,5	200
16094	103,0	103,0	300
16091	108,5	110,5	200
16095	108,5	114,8	200
16088	108,5	120,5	200

AFTER...

Ref. HOBI	Dia N°1 mm	Dia N°2 mm	L : en mm
16087	108,5	127,5	200
16084	110,5	114,8	200
16080	110,5	120,5	200
16085	110,5	127,5	200
16054	111,0	111,0	300
16081	114,8	127,5	200
16073	115,0	115,0	300
16079	120,5	127,5	200
16072	128,0	128,0	200

SLEEVES / COUPLINGS Dia Int./Ext.

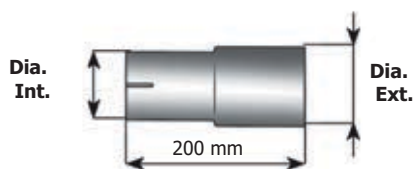

Ref. HOBI	Dia Int. mm	Dia Ext. mm	L : en mm
16046	64,5	70,0	200
16041	70,8	76,2	200
16003	76,7	88,9	200
16053	76,7	101,6	200
16005	89,4	101,6	200
16082	102,1	114,3	200
16773	102,1	127,0	200
16071	114,8	127,0	200

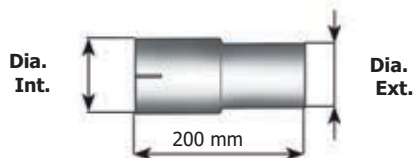

Ref. HOBI	Dia Int. mm	Dia Ext. mm	L : en mm
16019	89,4	76,2	200
16056	102,1	76,2	200
16096	102,1	88,9	200
16089	110,5	101,6	200
16083	114,8	101,6	200
16077	128,0	101,6	200

RUBBER

M 8

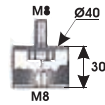

21190
81.96210.052

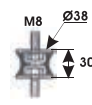

78577
0285530

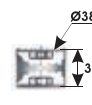

75560
98415197

M 10

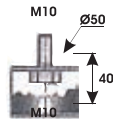

21565
81.96210.0101

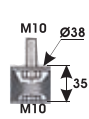

39139
697.987.0139

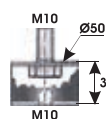

21189
81.96210.0153

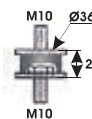

39189
001.987.5340

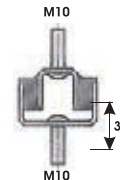

41592
4.771.333.000

M 12

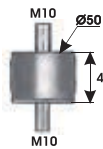

59121
324842

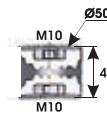

59138
1580440

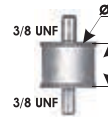

09590
36233 S1

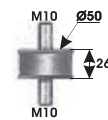

72196
104939-8

UNIVERSEL

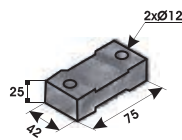

39187
667.490.0037

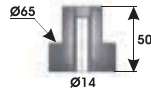

72197
100348-3

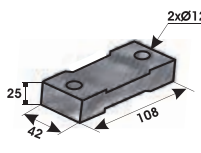

39192
309.490.0037



72192
117280-3

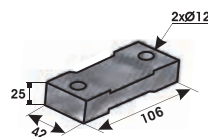

78575
0298390

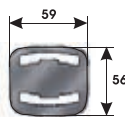

39591
381.492.0082



39153
901.492.0044

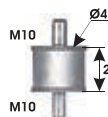

42592
5000750531

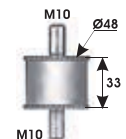

42580
5000750630

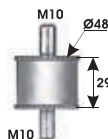

41580
4.771.244.000

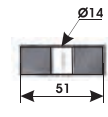

42598
0000689778

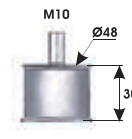

42574
5000750518

SPARK ARRESTOR « PL » (Heavy Vehicles)

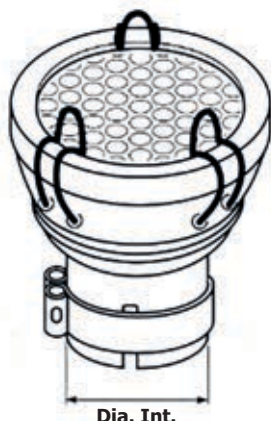

Package includes:

- A triple thickness grid
- A single thickness grid
- A trunnion necklace
- Reduction rings
- Cardboard packaging

Ref. HOBI	Dia. Int. mm
29594 (*)	45,5 - 50,5
29590	55,5
29595	60,5
29591	65,5
29589	70,5
29588	75,5
29587	80,5
29586	85,5
29582	90,5
29583	95,5
29584	101
29580	106
29585	111
29581	116
29579	121 - 126
29578	131 - 136

(*) ADAPTER



Réf. HOBI	Dia. Ext. mm	Dia. Int. mm
29676	50	45,5

SPARK ARRESTOR « VL » (Light Commercial Vehicle)



Package includes:

- Package includes:
- A triple thickness grid
- A single thickness grid
- A trunnion collar
- Reduction rings
- Cardboard packaging

Ref. HOBI	Dia. Int. mm
29599	32,5 - 39,0
29598	39,5 - 44,0
29597	44,5 - 49,0
29596	49,5 - 54,0
29592	54,5 - 59,0

Flame arrestor repair kit: PL

1 grille triple épaisseur



Ref. HOBI

1 grille simple épaisseur



3 crochets
1 couvercle



29577

Flame arrestor repair kit: VL

1 grille triple épaisseur



Réf. HOBI

1 grille simple épaisseur

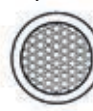

2 crochets
1 couvercle



29593



STANDARD MUFFLER

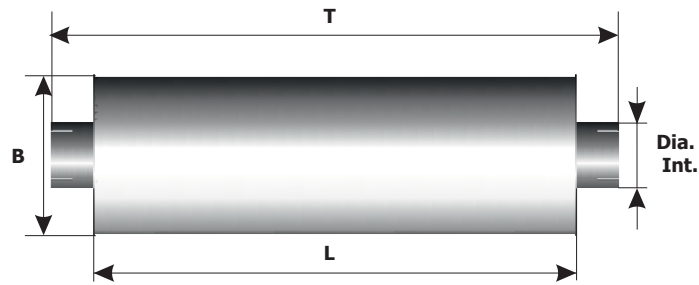

Ref. HOBI	T : en mm	L : en mm	B : en mm	Dia. Int en mm
50604	927	800	184	77
50651	927	800	184	89,50
50297	1145	965	184	102
50682	1219	1041	249	115
50670	1219	1041	249	128

FLEXIBLE STEEL WAVY + BRAID

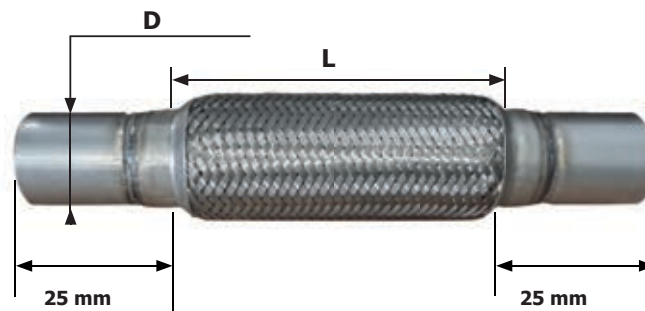

Ref. HOBI	Dia. Ext en mm	L : en mm	Ref. HOBI	Dia. Ext en mm	L : en mm
111202	40	150	111228	65	250
111205	45	150	131204	77	250
111208	48	200	131208	90	250
111211	51	200	131213	103	300
111216	57	250	131218	115	300
111220	61	250	131223	128	300
111224	63	250	-	-	-



hObi[®]

Exhaust Systems
Emission Control Systems
Air Tanks & Fuel Tanks



HobiEx OTOMOTIV A.S.

Ortakoy Mahallesi, Ilter Bulvari No:14/2
Silivri-Istanbul/TURKEY
Phone : +90 212 734 37 31
Fax : +90 212 734 37 35
E-mail : hobi@hobiex.com
Web : www.hobiex.com

Hobi France Srl.

9, rue Condorcet - Zone industrielle
94430 CHENNEVIERES sur MARNE
Tél : 00.33.(0)1.56.31.28.32
Fax : 00.33.(0)1.56.31.28.33
E-mail : hobi@hobifrance.com
Web : www.hobifrance.com